

# Köttermann 360°

Information on our products and services.



## 1. About us



## 2. Köttermann



## 3. Service



## 4. Products

Laboratory fume cupboards

Furniture

Services

Chemical storage cabinets

## 5. Safety



## 6. Sustainability



## 7. References

National

International

## 8. Contact





# 1. About us



2. Köttermann

3. Service

4. Products

5. Safety

6. Sustainability

7. References

8. Contact

# We furnish your laboratory so you can work safely

Your environment leads us to solutions:

**Laboratory furniture components** from Köttermann.

For your **maximum safety**. **Custom built** from **steel** – robust and durable.



1. About us

2. Köttermann

3. Service

4. Products

5. Safety

6. Sustainability

7. References

8. Contact



# Over 70 years of expertise

Requirements have shaped our company from day one. It all began in **1946** with equipment for pharmacies, and evolved into laboratory furniture. Since then, the town of Hänigsen in Lower Saxony has been the home of our products, all of which are **Made in Germany.**



**Distilling apparatus –**  
One of the first  
products from  
Köttermann

1. About us

2. Köttermann

3. Service

4. Products

5. Safety

6. Sustainability

7. References

8. Contact

# Change creates flexibility

Reinventing ourselves and adapting to changes is our core business. We also implement optimal solutions for every situation for our **customers in more than 40 industry sectors.**

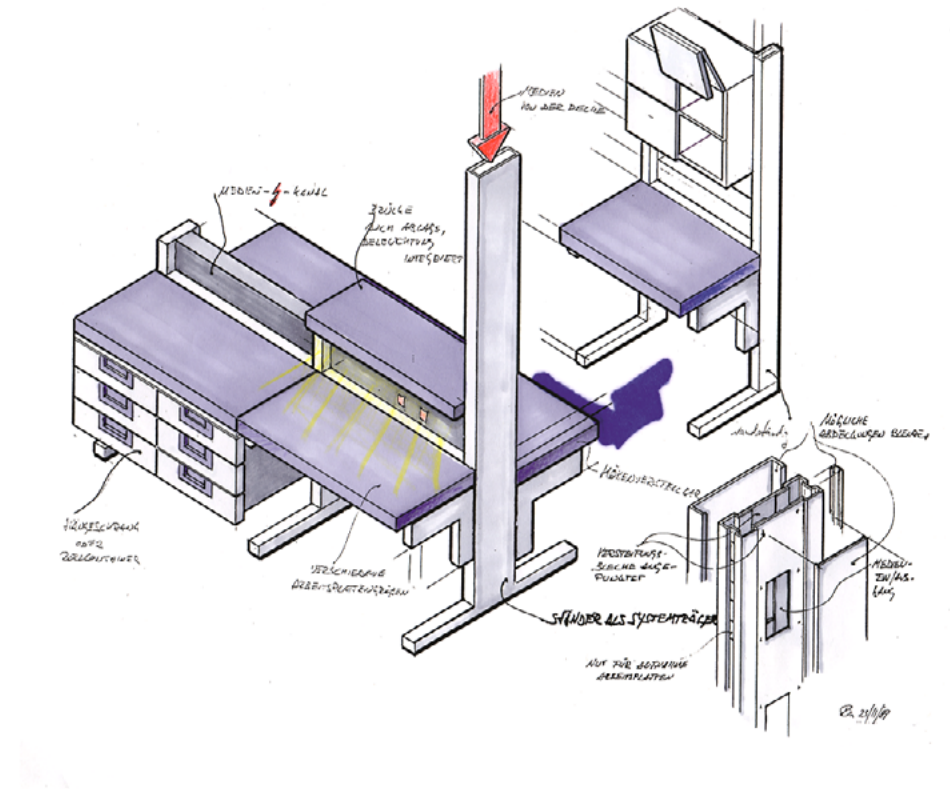
[1. About us](#)[2. Köttermann](#)[3. Service](#)[4. Products](#)[5. Safety](#)[6. Sustainability](#)[7. References](#)[8. Contact](#)



# Locations

**BLOCK Technical AG – Czech Republic (& Slovakia)**

**Köttermann GmbH – Hänigsen, Germany**

Köttermann companies:

- ✓ Köttermann bvba – Mechelen, Belgium (& Luxembourg)
- ✓ Köttermann B.V. – Breda, The Netherlands
- ✓ Köttermann Sp. Z O.O. – Warsaw, Poland  
(& Estonia, Latvia and Lithuania)
- ✓ Köttermann AG – Gossau, Switzerland
- ✓ Köttermann Systemlabor S.A. – Madrid, Spain (& Portugal)

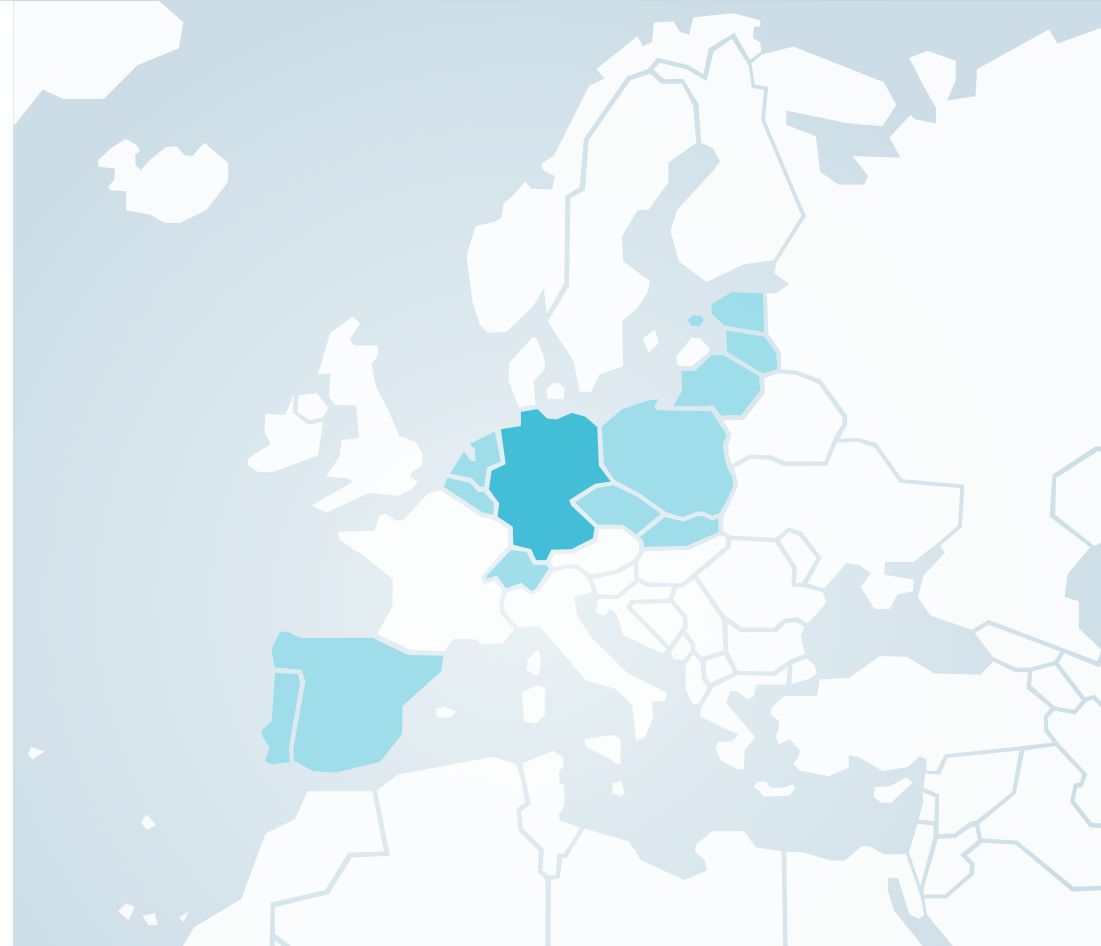

1. About us

2. Köttermann

3. Service

4. Products

5. Safety

6. Sustainability

7. References

8. Contact

# One team

»Our employees are not only the basis of our success, their passion contributes to the uniqueness of our products.«

Jens Buchholz

»We are grateful for a team that accompanies changes at all times and we are proud that so many colleagues have been loyal to us for decades.«

Kazim Doyuran

**140 employees** make up our core team in Hänigsen. These are supported internationally by a great many long-standing partners.



1. About us

2. Köttermann

3. Service

4. Products

5. Safety

6. Sustainability

7. References

8. Contact



# Sales Team Germany



Alexander Voerster



Hans-Jürgen Laur



Stefan Hering



Andreas Bundel

1. About us

2. Köttermann

3. Service

4. Products







5. Safety

6. Sustainability

7. References

8. Contact

# International Area Sales Managers

-  **Habib Heni** – Africa
-  **Hans Laut** – North/Central America and Latin America
-  **Amar Hegde** – Middle East
-  **Eugene Lai** – Asia and Australia
-  **Konstantin Abuzyarov** (Köttermann Russia) –  
Commonwealth of Independent States (CIS)
-  **Alenka Konic** – France
-  **Terence Hathaway** – UK / Ireland

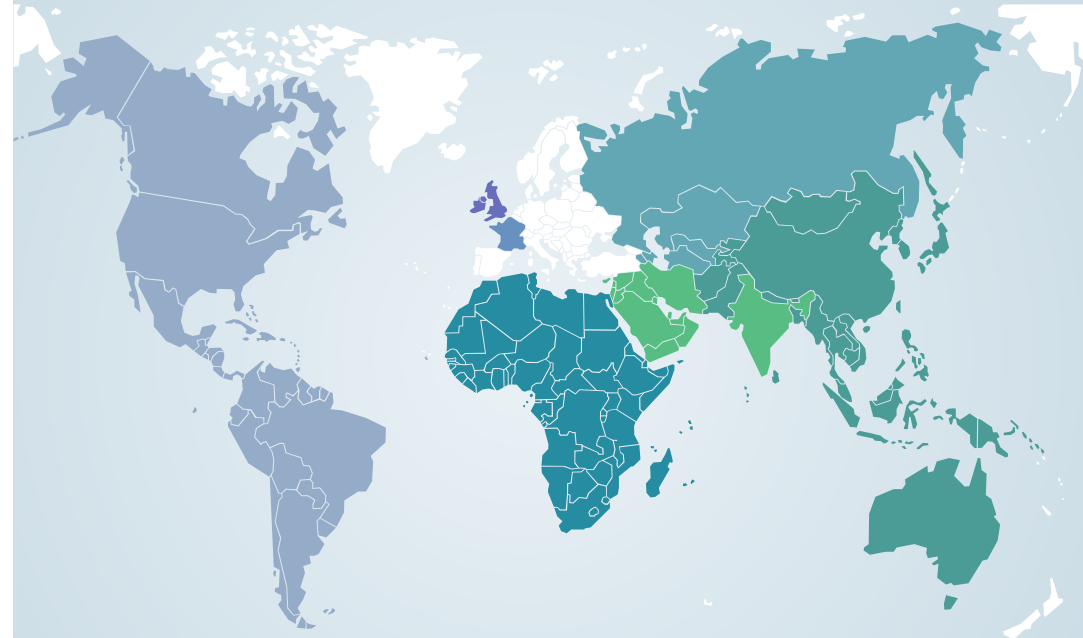

1. About us

2. Köttermann

3. Service

4. Products

5. Safety

6. Sustainability

7. References

8. Contact



# A site for diversity

Whether for training courses, certifications, events or room to think: the **Köttermann Academy** offers creative space as well as advanced technical support.



Artist's rendition



1. About us

2. Köttermann

3. Service

4. Products

5. Safety

6. Sustainability

7. References

8. Contact

# Hands-on laboratory

Exploring and trying out possibilities. The **Köttermann Showroom** gives you not only a sense of your future environment, but also room for ideas. You might also do your product photoshoot here.



1. About us

2. Köttermann

3. Service

4. Products

5. Safety

6. Sustainability

7. References

8. Contact



# Köttermann trust

- ✓ **Over 70 years** of custom-built laboratory furniture
- ✓ Exclusive **production at the Hänigsen location**
- ✓ **140 employees**
- ✓ Turnover of **EUR 27 million** in **2019**
- ✓ More than **1,000 international projects** per year
- ✓ Accredited **certifications**
- ✓ Products based on sustainable **steel**



Historical catalog titles

1. About us

2. Köttermann

3. Service

4. Products

5. Safety

6. Sustainability

7. References

8. Contact

# Köttermann & BLOCK®

We joined the international BLOCK® group of companies at the **end of 2018**. As a manufacturer of steel laboratory furniture, our products perfectly complement the portfolio of **high-tech cleanroom solutions**.



1. About us

2. Köttermann

3. Service

4. Products

5. Safety

6. Sustainability

7. References

8. Contact

# BLOCK<sup>®</sup> group

- Headquarters: Valašské Meziříčí (Valmez) in the **Czech Republic**
- Established in **1991**
- Over **400 employees**
- Branches in 11 countries, authorised partners in 39 countries
- Four production locations



1. About us

2. Köttermann

3. Service

4. Products

5. Safety

6. Sustainability

7. References

8. Contact



## 2. Köttermann

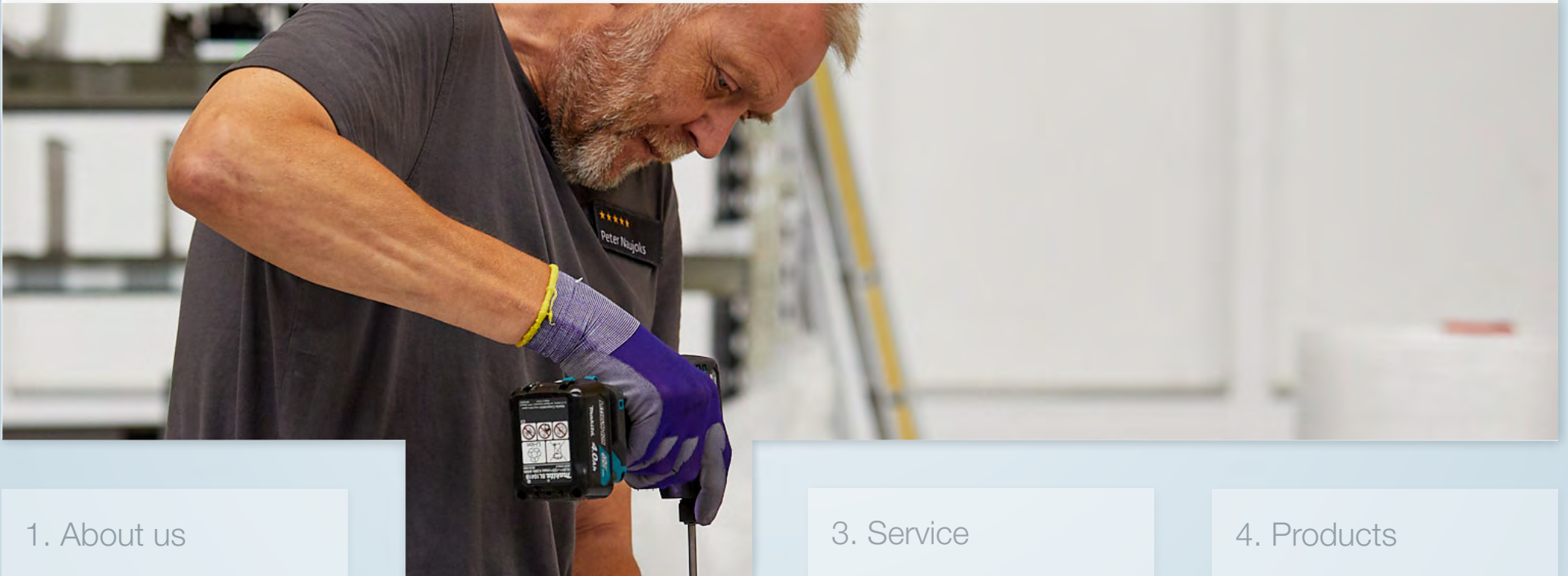

1. About us

3. Service

4. Products

5. Safety

6. Sustainability

7. References

8. Contact



# Steel – more than robust

Laboratories are set up for the long term. We work with **steel**, a material that lasts for many years and is also fully recyclable.

[1. About us](#)[2. Köttermann](#)[3. Service](#)[4. Products](#)[5. Safety](#)[6. Sustainability](#)[7. References](#)[8. Contact](#)

# Durability

Steel is virtually **indestructible**. Steel laboratory furniture is made to meet the highest demands.

[1. About us](#)[2. Köttermann](#)[3. Service](#)[4. Products](#)[5. Safety](#)[6. Sustainability](#)[7. References](#)[8. Contact](#)

# Resistance

Steel is resistant to **temperature fluctuations, corrosion, humidity, water vapour, water and acids**, including **fatty acids, organic acids, and inorganic acids**.

[1. About us](#)[2. Köttermann](#)[3. Service](#)[4. Products](#)[5. Safety](#)[6. Sustainability](#)[7. References](#)[8. Contact](#)



# Recyclability

Steel is up to **100 percent recyclable**. The properties of the material remain intact with the same quality in every stage of recycling.

[1. About us](#)[2. Köttermann](#)[3. Service](#)[4. Products](#)[5. Safety](#)[6. Sustainability](#)[7. References](#)[8. Contact](#)



# Sustainability

Multi-recycling capability: Steel can be recycled over multiple life cycles, thus avoiding **50 percent** of original **CO<sub>2</sub> emissions**.

[1. About us](#)[2. Köttermann](#)[3. Service](#)[4. Products](#)[5. Safety](#)[6. Sustainability](#)[7. References](#)[8. Contact](#)

# Hygiene

Steel laboratory furniture is **hygienic**, **easy to clean** and **decontaminate**.



1. About us

2. Köttermann

3. Service

4. Products

5. Safety

6. Sustainability

7. References

8. Contact

# Practical

Steel is **magnetic**, so important data sheets or notices can easily be affixed to **furniture** or **service cells**.

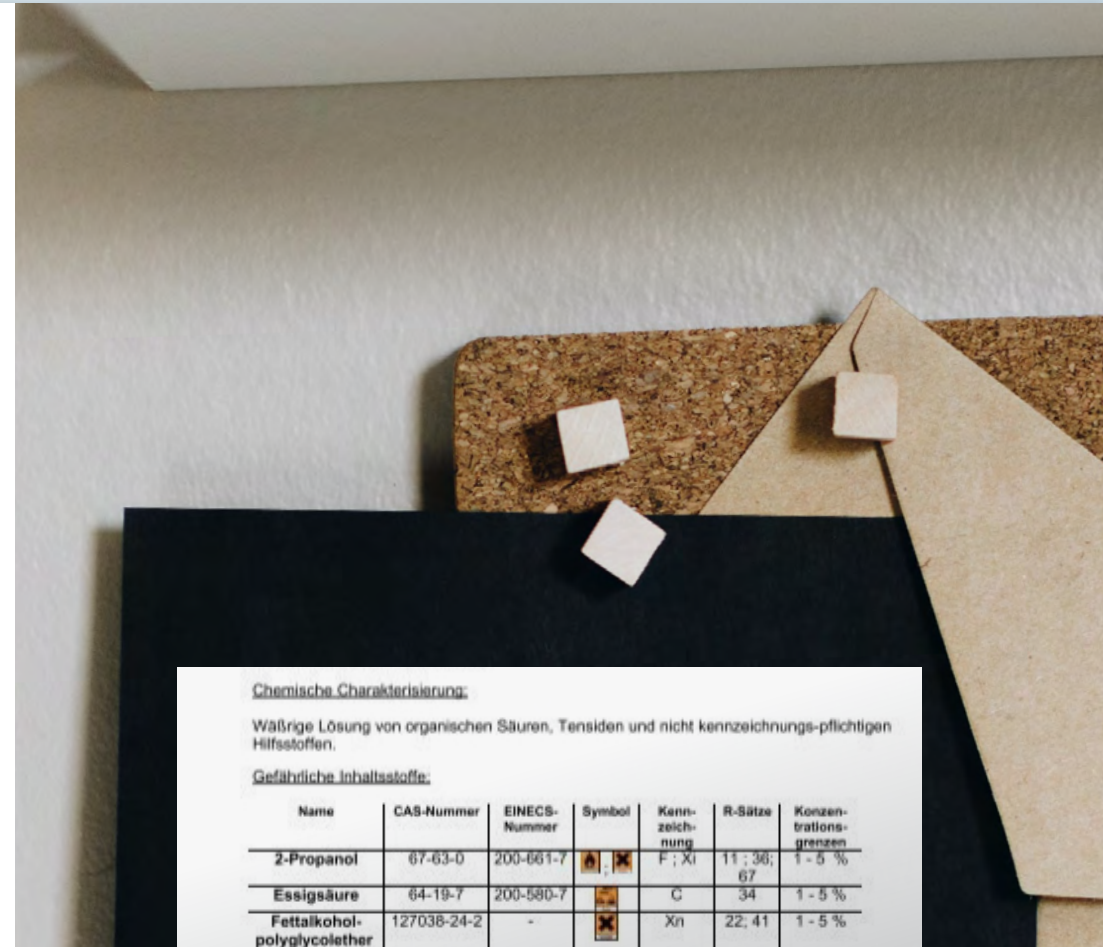

1. About us

2. Köttermann

3. Service

4. Products

5. Safety

6. Sustainability

7. References

8. Contact



# As individual as your rooms

Every laboratory is **unique**. Your needs and circumstances define our framework. Our **furniture modules** can be combined **flexibly** to give you an optimal working environment.

[1. About us](#)[2. Köttermann](#)[3. Service](#)[4. Products](#)[5. Safety](#)[6. Sustainability](#)[7. References](#)[8. Contact](#)



# A change in plans?

We find the right solution for you in every situation. And if you want to **update** or **modify an existing laboratory**, we work with you to develop a new concept that meets your needs.

[1. About us](#)[2. Köttermann](#)[3. Service](#)[4. Products](#)[5. Safety](#)[6. Sustainability](#)[7. References](#)[8. Contact](#)

# 3. Service

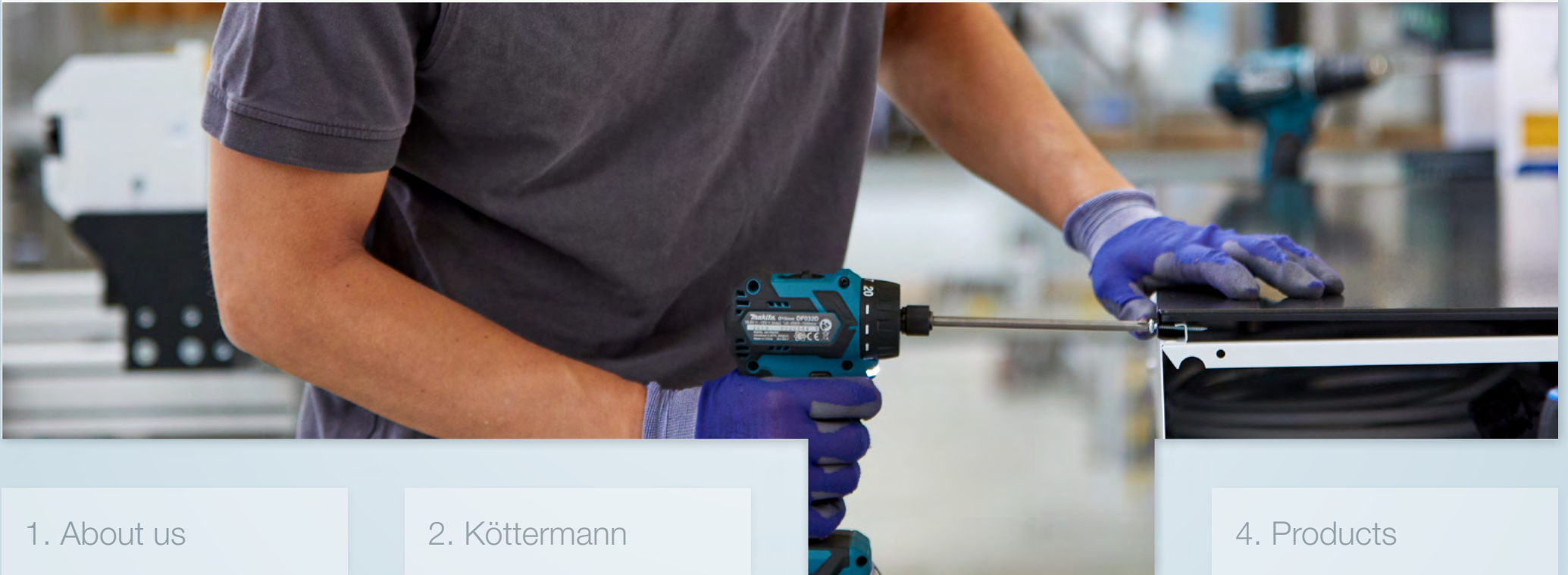

1. About us

2. Köttermann

4. Products

5. Safety

6. Sustainability

7. References

8. Contact

# Everything from a single source

We are here for you from the first **consultation meeting** to the **handover of your operational laboratory**. We work with you to find the right solution, no matter whether it's for a new laboratory or modifications to an existing laboratory.



1. About us

2. Köttermann

3. Service

4. Products

5. Safety

6. Sustainability

7. References

8. Contact



# Need-oriented: Analysis and advice

Before we start manufacturing your new laboratory furniture, we **discuss your needs in detail** and **analyse your work processes**. We plan your **custom solution** only after in-depth advice.



1. About us

2. Köttermann

3. Service

4. Products

5. Safety

6. Sustainability

7. References

8. Contact

# Transparency: 3D design and planning

We transform your wishes into reality as early as the planning stage. To give you an **instant early impression** of your new laboratory, we present you with a **3D** preview.



1. About us

2. Köttermann

3. Service

4. Products

5. Safety

6. Sustainability

7. References

8. Contact

# Quality counts: Production at our headquarters

We have **short** paths between **planning** and **manufacturing**. Our production is order-driven with very short lead times, and exclusively in Hänigsen. With nearly **75 years of experience**, we deliver quality products that are **Made in Germany** for unsurpassed safety.

[1. About us](#)[2. Köttermann](#)[3. Service](#)[4. Products](#)[5. Safety](#)[6. Sustainability](#)[7. References](#)[8. Contact](#)



# Seamless: Reliable logistics

With the aid of certified partners and an effective **logistics network**, we deliver **worldwide** – safely, reliably and on time.

We currently offer **particularly short delivery times** of just **4 to 5 weeks**.



1. About us

2. Köttermann

3. Service

4. Products

5. Safety

6. Sustainability

7. References

8. Contact

# Precise: Setup and commissioning

We place high priority on careful **installation** of your laboratory furniture.

No matter where you are in the world, **Köttermann installers** or our **trained partners** are always nearby. As much as possible, we assemble your products in the factory so that they fit perfectly and the setup time is short.

[1. About us](#)[2. Köttermann](#)[3. Service](#)[4. Products](#)[5. Safety](#)[6. Sustainability](#)[7. References](#)[8. Contact](#)

# At your side: Maintenance and service

After installation, we are still there for you, and can handle all **service and maintenance tasks** if so desired.



1. About us

2. Köttermann

3. Service

4. Products

5. Safety

6. Sustainability

7. References

8. Contact



# 4. Products



1. About us

2. Köttermann

3. Service

5. Safety

6. Sustainability

7. References

8. Contact

# Our products



Laboratory fume cupboards



Furniture



Services



Chemical storage cabinets

1. About us

2. Köttermann

3. Service

4. Products

5. Safety

6. Sustainability

7. References

8. Contact

# Room for research

Working safely in the laboratory. Easy operation combined with the best possible protection for simplified work processes.

✓ Certification compliant with **EN 14175**

Part 2, Part 3, and Part 7

✓ Tested for a **20 year durability period**



1. About us

2. Köttermann

3. Service

4. Products

5. Safety

6. Sustainability

7. References

8. Contact



# Universal and modular

Many different types of laboratory and laboratory activities demand adaptable fume cupboards. That's why we listen closely and give you detailed advice. For each application, we configure a fume cupboard according to your specific needs so you can work safely.

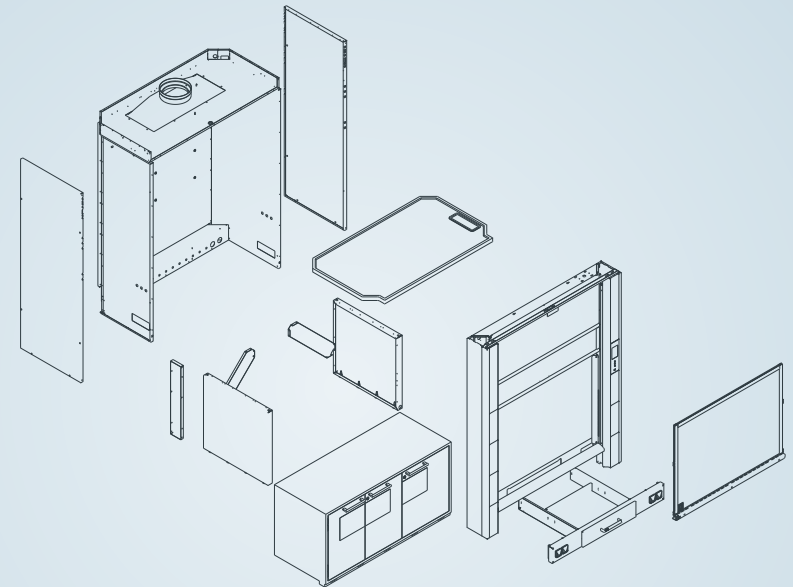

1. About us

2. Köttermann

3. Service

4. Products

5. Safety

6. Sustainability

7. References

8. Contact

# Your benefits

- ✓ **Sustainability:** Optimised environmental and economic balance
- ✓ **Cost-effectiveness:** Minimum consumption with maximum safety
- ✓ **Need oriented:** Laboratory fume cupboards designed around your applications



1. About us

2. Köttermann

3. Service

4. Products

5. Safety

6. Sustainability

7. References

8. Contact

# Custom and safe

- ✓ Powder coated **steel** housing
- ✓ **Safe lining** depending on application area and fume cupboard
- ✓ Laminated safety glass **sash**
- ✓ **Flow-optimised** fume extraction system
- ✓ Large interior depth provides **plenty of room for equipment**



1. About us

2. Köttermann

3. Service

4. Products

5. Safety

6. Sustainability

7. References

8. Contact



# Custom and safe

- ✓ **Custom** gas, water, and electrical fittings
- ✓ Electrical cables **free of halogenated hydrocarbons**
- ✓ **Cable routing** through the inlet profile on the worktop
- ✓ **Easy operation** and monitoring by airflow monitoring – AFM+



1. About us

2. Köttermann

3. Service

4. Products

5. Safety

6. Sustainability

7. References

8. Contact

# At a glance



## **Bench type fume cupboards**

General purpose fume cupboards



## **EXPLORIS EcoPlus®**

The energy-efficient fume cupboard for maximum sustainability



## **High-performance fume cupboards**

Secure protection for working with acids and high thermal loads

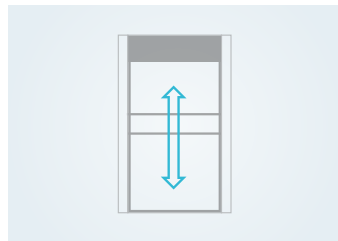

**Distillation and walk-in fume cupboards** For reliable housing of tall test apparatus



## **Radionuclide fume cupboards**

Maximum safety for handling radioactive substances



## **Pharmacy fume cupboards**

Compact and versatile

1. About us

2. Köttermann

3. Service

4. Products

5. Safety

6. Sustainability

7. References

8. Contact

# Your work is what matters

When selecting a fume cupboard, the most important considerations are the activities you do and the substances you use.



## Fume cupboards for general use with chemical-resistant Trespa TopLab® Vertical lining

	Suitable	Occasional use	Not suitable
Organic solvents	x		
Weak acids	x		
Diluted inorganic acids	x		
Cold concentrated inorganic acids	x		
Hot concentrated inorganic acids		x	
Hydrofluoric acid			x
Radioactive substances			x
High thermal load			x

[1. About us](#)[2. Köttermann](#)[3. Service](#)[4. Products](#)[5. Safety](#)[6. Sustainability](#)[7. References](#)[8. Contact](#)



# Fume cupboards for general use

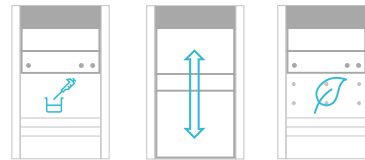

	Suitable	Occasional use	Not suitable
Organic solvents	x		
Weak acids	x		
Diluted inorganic acids	x		
Cold concentrated inorganic acids		x	
Hot concentrated inorganic acids			x
Hydrofluoric acid			x
Radioactive substances			x
High thermal load			x

When selecting a fume cupboard, the most important considerations are the activities you do and the substances you use.

[1. About us](#)
[2. Köttermann](#)
[3. Service](#)
[4. Products](#)
[5. Safety](#)
[6. Sustainability](#)
[7. References](#)
[8. Contact](#)

# High-performance fume cupboard with polypropylene (PP) lining



When selecting a fume cupboard, the most important considerations are the activities you do and the substances you use.

	Suitable	Occasional use	Not suitable
Organic solvents		x	
Weak acids		x	
Diluted inorganic acids		x	
Cold concentrated inorganic acids		x	
Hot concentrated inorganic acids		x	
Hydrofluoric acid	x		
Radioactive substances			x
High thermal load	x		

[1. About us](#)[2. Köttermann](#)[3. Service](#)[4. Products](#)[5. Safety](#)[6. Sustainability](#)[7. References](#)[8. Contact](#)

# High-performance fume cupboard with ceramic lining



When selecting a fume cupboard, the most important considerations are the activities you do and the substances you use.

	Suitable	Occasional use	Not suitable
Organic solvents	x		
Weak acids	x		
Diluted inorganic acids	x		
Cold concentrated inorganic acids	x		
Hot concentrated inorganic acids	x		
Hydrofluoric acid		x	
Radioactive substances		x	
High thermal load	x		

[1. About us](#)[2. Köttermann](#)[3. Service](#)[4. Products](#)[5. Safety](#)[6. Sustainability](#)[7. References](#)[8. Contact](#)



# Radionuclide fume cupboard



	Suitable	Occasional use	Not suitable
Organic solvents	x		
Weak acids	x		
Diluted inorganic acids	x		
Cold concentrated inorganic acids		x	
Hot concentrated inorganic acids		x	
Hydrofluoric acid		x	
Radioactive substances	x		
High thermal load		x	

When selecting a fume cupboard, the most important considerations are the activities you do and the substances you use.

[1. About us](#)[2. Köttermann](#)[3. Service](#)[4. Products](#)[5. Safety](#)[6. Sustainability](#)[7. References](#)[8. Contact](#)

# All-rounders for general use



Ideal for working with organic solvents and cold or diluted acids. Depending on the ceiling height of your laboratory, you can choose between tall or low designs.



1. About us

2. Köttermann

3. Service

4. Products

5. Safety

6. Sustainability

7. References

8. Contact

- ✓ Fume cupboard for low ceiling height with unique low installation height (2250 mm)
- ✓ Above-average usable worktop depth
- ✓ Underbench storage for tall utensils up to 720 mm
- ✓ Metallic construction enables columns with hollow spaces at the front – for easy maintenance and protection against air leakage
- ✓ Side or front service connections for easy tapping of water, gas, etc.



1. About us

2. Köttermann

3. Service

4. Products

5. Safety

6. Sustainability

7. References

8. Contact



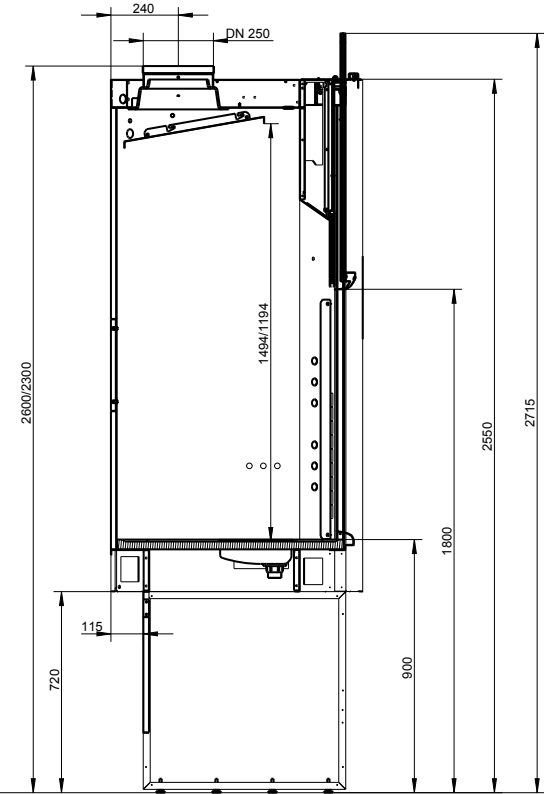

Width	1200	1500	1800	2000	2100
Front height	2300 / 2550	2300 / 2550	2300 / 2550	2300 / 2550	2300 / 2550
Chamber height	2300 / 2600	2300 / 2600	2300 / 2600	2300 / 2600	2300 / 2600
Depth	900	900	900	900	900
Usable space width	1100	1400	1700	1900	2000
Usable space height	1190 / 1490	1190 / 1491	1190 / 1492	1190 / 1493	1190 / 1494
Usable space depth	800	800	800	800	800
Work height	900	900	900	900	900
Minimal permissible volume flow rate**	450	530	680	800	800
Specified volume flow rate	480	600	720	840	840
Maximum permissible volume flow rate	1500	1500	1500	1500	1500

Dimensions [mm] / Volume flow rate [m³/h]

\*\* Alarm value

1. About us

2. Köttermann

3. Service

4. Products

5. Safety

6. Sustainability

7. References

8. Contact

# Sustainable safety and cost-effectiveness



With its unique flow technology, the energy-efficient **EcoPlus®** fume cupboard reduces the air flow rate while meeting all safety requirements. The allows operating cost **savings** up to **30%** relative to a comparable standard model.



1. About us

2. Köttermann

3. Service

4. Products

5. Safety

6. Sustainability

7. References

8. Contact

- ✓ Safety through flow-optimised geometry without complicated auxiliary air flow technology
- ✓ Operation with exemplary low 250 m³/h per linear metre of fume cupboard width
- ✓ Smaller duct cross-sections and smaller sized fans reduce capital expenditure for the fume extraction system
- ✓ Bench type fume cupboards are available in EcoPlus® variants and can be retrofitted afterwards

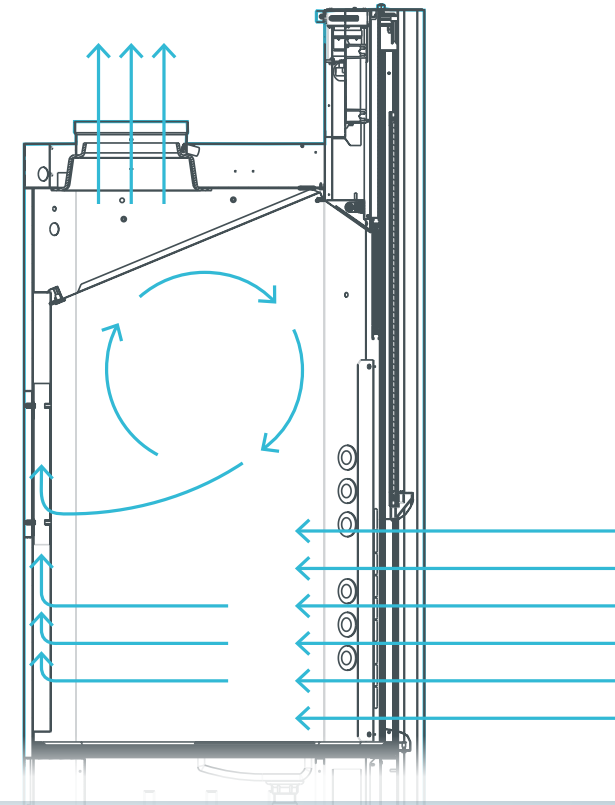

1. About us

2. Köttermann

3. Service

4. Products

5. Safety

6. Sustainability

7. References

8. Contact



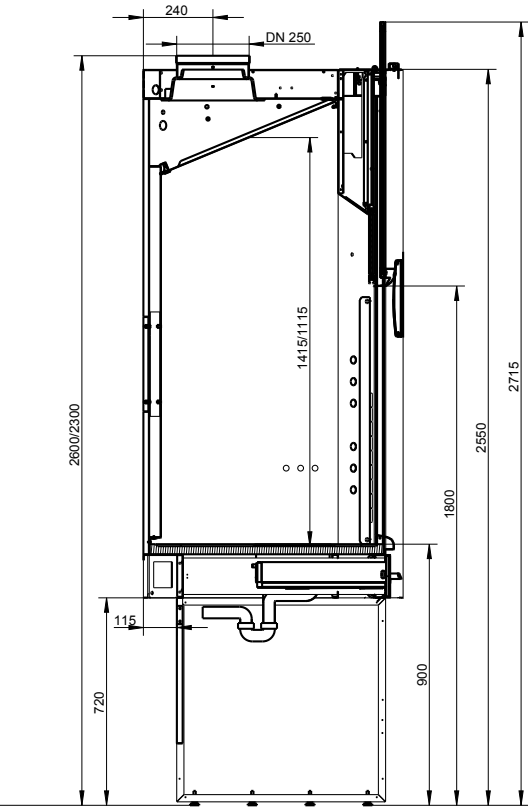

# Potential savings

	Conventional fume cupboard		EXPLORIS EcoPlus®		Savings with EXPLORIS EcoPlus®
	m³	€	m³	€	€
Operating time per fume cupboard (1,500 mm fume cupboard)					
1 hour	600	0.48	375	0.30	<b>0.18</b>
1 day (8 hours)	4,800	3.84	3,000	2.40	<b>1.44</b>
1 year (250 days at 8 hours per day)	1,200,000	960.00	750,000	600.00	<b>360.00</b>
1 year (250 days at 24 hours per day)	3,600,000	2,880.00	2,250,000	1,800.00	<b>1,080.00</b>

Dimensions [mm] / Volume flow rate [m³/h]

Assumption: 1,000 m³ of conditioned laboratory air costs €0.80.

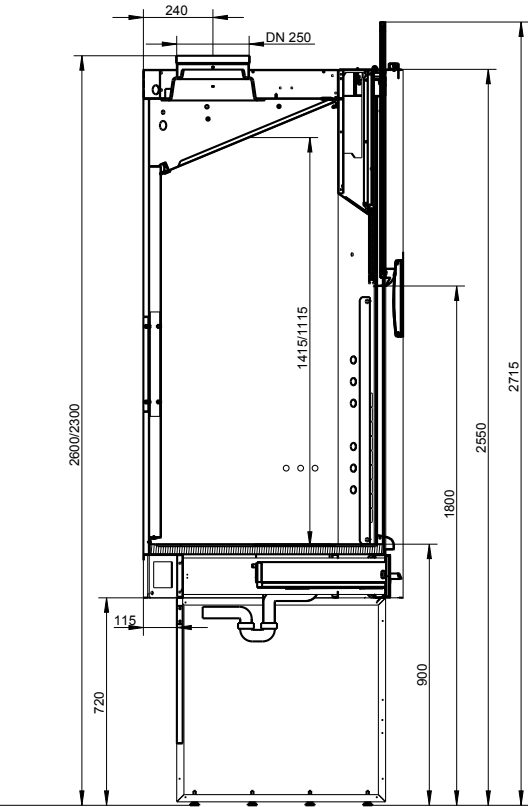

Width	1200	1500	1800	2000	2100
Front height	2300/2550	2300/2550	2300/2550	2300/2550	2300/2550
Chamber height	2300/2600	2300/2600	2300/2600	2300/2600	2300/2600
Depth	900	900	900	900	900
Usable space width	1100	1400	1700	1900	2000
Usable space height	1115 / 1415	1115 / 1415	1115 / 1415	1115 / 1415	1115 / 1415
Usable space depth	760	760	760	760	760
Work height	900	900	900	900	900
Minimal permissible volume flow rate**	300	375	450	530	530
Specified volume flow rate	360	450	540	630	630
Maximum permissible volume flow rate	1500	1500	1500	1500	1500

Dimensions [mm] / Volume flow rate [m³/h]

\*\* Alarm value

1. About us

2. Köttermann

3. Service

4. Products

5. Safety

6. Sustainability

7. References

8. Contact

# Resistant to acids and high thermal loads



High-performance fume cupboards are able to resist high thermal loads. Work safely, even for distillation fuming with strong inorganic acids, including sulphuric acid, nitric acid, hydrochloric acid and aqua regia.



1. About us

2. Köttermann

3. Service

4. Products

5. Safety

6. Sustainability

7. References

8. Contact

- ✓ Certified compliant with EN 14175
- ✓ Ceramic or polypropylene lining for chemical resistance
- ✓ Special air technology enables working with high thermal loads and heat dissipation
- ✓ Exhaust air scrubber for air purification



1. About us

2. Köttermann

3. Service

4. Products

5. Safety

6. Sustainability

7. References

8. Contact



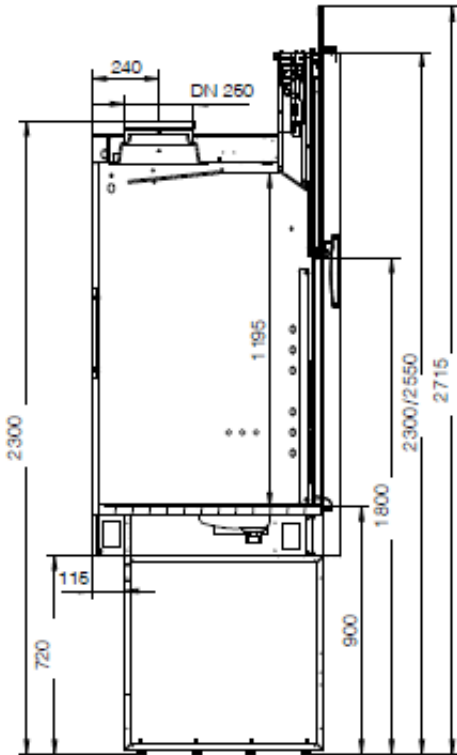

Width	1200	1500	1800	2000	2100
Front height	2300 / 2550	2300 / 2550	2300 / 2550	2300 / 2550	2300 / 2550
Chamber height	2300	2300	2300	2300	2300
Depth	900	900	900	900	900
Usable space width with PP lining	1090	1390	1690	1890	1990
Usable space width with ceramic lining	1080	1380	1680	1880	1980
Usable space height	1195	1195	1195	1195	1195
Usable space depth with PP lining	795	795	795	795	795
Usable space depth with ceramic lining	792	792	792	792	792
Work height	900	900	900	900	900
Minimal permissible volume flow rate**	660	830	990	1790	1790
Specified volume flow rate	720	900	1080	1900	1900
Maximum permissible volume flow rate	1500	1500	1500	2000	2000

Dimensions [mm] / Volume flow rate [m³/h]

\*\* Alarm value

## 1. About us

## 2. Köttermann

### 3. Service

## 4. Products

## 5. Safety

## 6. Sustainability

## 7. References

## 8. Contact

# More room for working safely

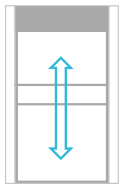

Tall apparatus needs a lot of space. Distillation and walk-in fume cupboards are ideal in this regard. Distillation fume cupboards feature an especially low worktop, while walk-in fume cupboards provide enough room for large apparatus.



1. About us

2. Köttermann

3. Service

4. Products

5. Safety

6. Sustainability

7. References

8. Contact

# More room for working safely

- ✓ Higher interior for especially large apparatus, for example for distillation or preparative column chromatography
- ✓ Two-part sash with two panes of laminated safety glass, end-to-end glazed or with a sliding pane



1. About us

2. Köttermann

3. Service

4. Products

5. Safety

6. Sustainability

7. References

8. Contact

Distillation fume cupboard

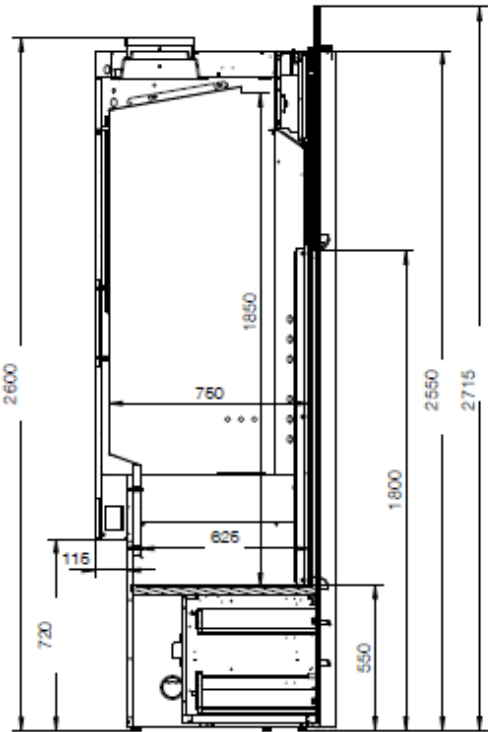

Width	1200	1500	1800	2000	2100
Front height	2550	2550	2550	2550	2550
Chamber height	2600	2600	2600	2600	2600
Depth	900	900	900	900	900
Usable space width	910 / 1100	1210 / 1400	1510 / 1700	1710 / 1900	1810 / 2000
Usable space height	1850	1850	1850	1850	1850
Usable space depth	625 / 750	625 / 750	625 / 750	625 / 750	625 / 750
Work height	550	550	550	550	550
Minimal permissible volume flow rate**	600	750	900	1050	1050
Specified volume flow rate	630	790	950	1110	1110
Maximum permissible volume flow rate	1500	1500	1500	1500	1500

Dimensions [mm] / Volume flow rate [m³/h]

\*\* Alarm value

1. About us

2. Köttermann

3. Service

4. Products

5. Safety

6. Sustainability

7. References

8. Contact



Walk-in fume cupboard

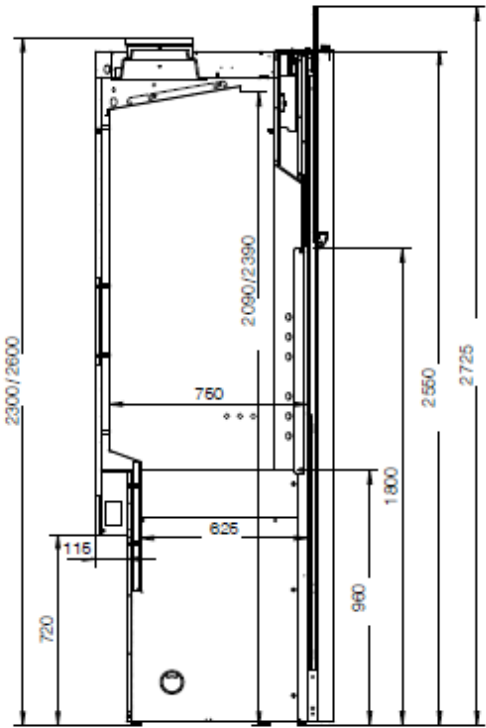

Width	1200	1500	1800	2000	2100
Front height	2550	2550	2550	2550	2550
Chamber height	2300 / 2600	2300 / 2600	2300 / 2600	2300 / 2600	2300 / 2600
Depth	900	900	900	900	900
Usable space width	910 / 1100	1210 / 1400	1510 / 1700	1710 / 1900	1810 / 2000
Usable space height	2090 / 2390	2090 / 2390	2090 / 2390	2090 / 2390	2090 / 2390
Usable space depth	625 / 750	625 / 750	625 / 750	625 / 750	625 / 750
Minimal permissible volume flow rate**	660	830	990	1160	1160
Specified volume flow rate	750	940	1120	1310	1310
Maximum permissible volume flow rate	2000	2000	2000	2000	2000

Dimensions [mm] / Volume flow rate [m³/h]

\*\* Alarm value

# Specifically for handling radioactive substances

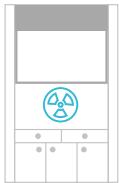

So you can work safely: Radionuclide fume cupboards protect against radiation and substance escape and are easy to decontaminate. For extremely stringent requirements, a fully welded stainless steel interior with few seams can be installed.



1. About us

2. Köttermann

3. Service

4. Products

5. Safety

6. Sustainability

7. References

8. Contact

- ✓ Design and construction compliant with DIN 25466
- ✓ Sash with access openings
- ✓ Stainless steel worktop
- ✓ Low air volume flow possible
  - Load capacity of more than 1.5 t allows the addition of lead shielding
  - Optional lead lining under worktop



1. About us

2. Köttermann

3. Service

4. Products

5. Safety

6. Sustainability

7. References

8. Contact

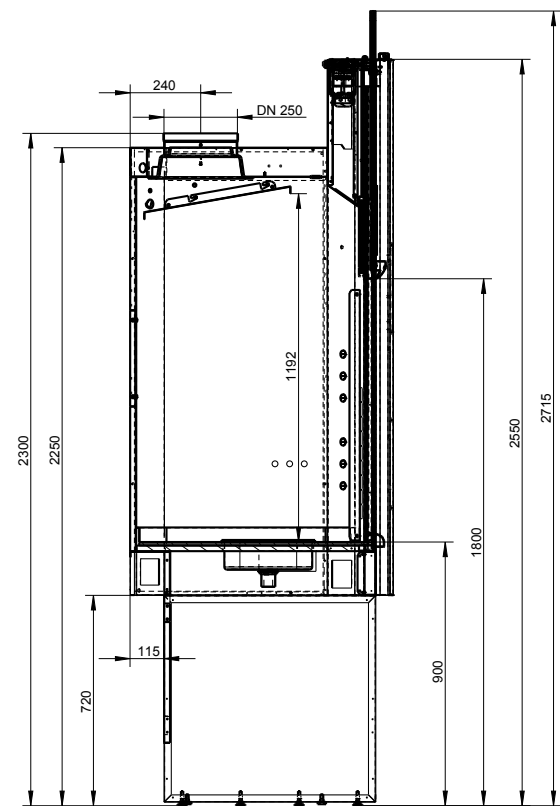

Width	1200	1500
Front height	2550	2550
Chamber height	2300	2300
Depth	900	900
Usable space width	1100	1400
Usable space height	1190	1190
Usable space depth	800	800
Work height	900	900
Minimal permissible volume flow rate**	450	720
Specified volume flow rate	500	800
Maximum permissible volume flow rate	1500	1500

Dimensions [mm] / Volume flow rate [m³/h]

\*\* Alarm value



# Protection in a very small package



Pharmacy fume cupboards are space-saving and versatile small fume cupboards specifically designed for handling hazardous substances in pharmacies.



1. About us

2. Köttermann

3. Service

4. Products

5. Safety

6. Sustainability

7. References

8. Contact

- ✓ Certified compliant with DIN 12924 Part 4
- ✓ Fulfil the requirements of Section 4 paragraph 2 of the German Ordinance on the Operation of Pharmacies
- ✓ For working safely with dust-forming preparations and volatile chemicals in small laboratories
- ✓ Integrated air flow monitoring
- ✓ Connection to customer-provided fume extraction system
- ✓ Fully adjustable polyacrylic sash

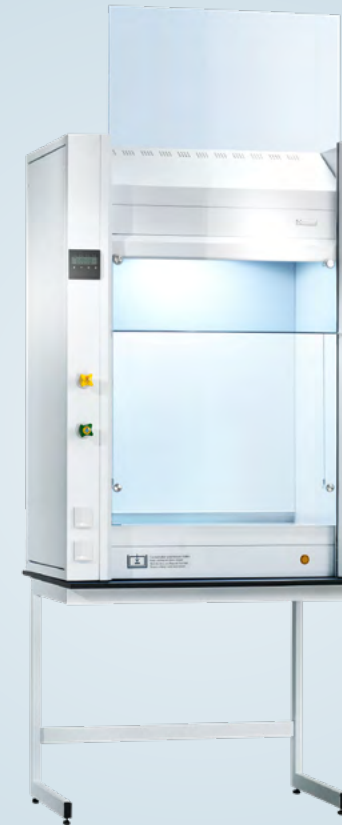

1. About us

2. Köttermann

3. Service

4. Products

5. Safety

6. Sustainability

7. References

8. Contact

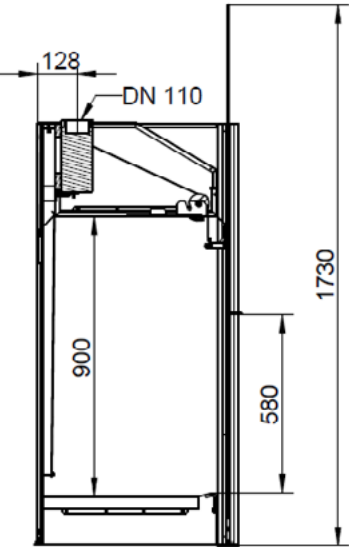

Width	900	900	900	900
Front height	1350	1350	1350	1350
Depth	640	640	640	640
Usable space width	795	795	795	795
Usable space height	900	900	900	900
Usable space depth	570	570	570	570
Fan	X	-	-	X
Services	X	X	-	-
Minimum required volume flow rate	250	250	250	250

Dimensions [mm] / Volume flow rate [m³/h]

\*\* Alarm value

1. About us

2. Köttermann

3. Service

4. Products

5. Safety

6. Sustainability

7. References

8. Contact

# Maximum safety and long life

- ✓ Custom built and robust – modular laboratory furniture made of steel.
- ✓ Matched to your needs, planned for maximum safety.



1. About us

2. Köttermann

3. Service

4. Products

5. Safety

6. Sustainability

7. References

8. Contact

# In the laboratory it's the details that count

Our versatile laboratory furniture can be used and combined as required. All modules can easily be exchanged and retrofitted.



1. About us

2. Köttermann

3. Service

4. Products

5. Safety

6. Sustainability

7. References

8. Contact



# Furniture for working safely in the laboratory

- ✓ Tested internally and externally, and certified by independent institutes
- ✓ Made of electro-galvanised steel – robust and durable
- ✓ Coated to resist UV and chemicals



1. About us

2. Köttermann

3. Service

4. Products

5. Safety

6. Sustainability

7. References

8. Contact

# Quality, space and design

- ✓ Maximum storage space
- ✓ Double-wall, soundproofed doors and drawer fronts
- ✓ Convenient pull-outs with air-damped automatic self-closing
- ✓ Clear and aesthetic colour scheme
- ✓ Ergonomic product design



1. About us

2. Köttermann

3. Service

4. Products

5. Safety

6. Sustainability

7. References

8. Contact

You have the  
space – we have  
the matching  
product

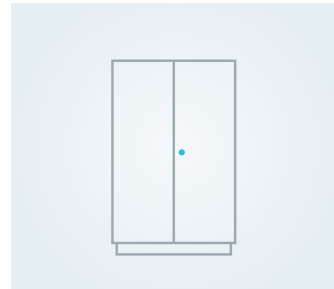

**Tall cabinets**

Storage space with many extras



**Underbench cabinets**

Secure and convenient storage

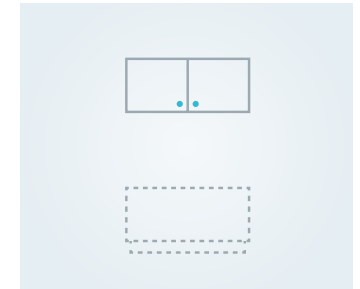

**Wall-mounted and top-mounted cabinets** Tidily organised and handy storage



**Cell cabinets**

Transparency on island benches

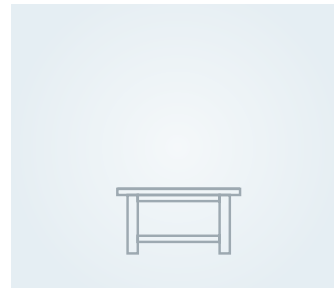

**Single benches**

Mobile with high load capacity



**Worktops**

Tailored to your requirements



**Basins and sinks**

Wet cells made to measure

1. About us

2. Köttermann

3. Service

4. Products

5. Safety

6. Sustainability

7. References

8. Contact

# Lots of room for equipment and utensils

- ✓ Versions that meet your needs
- ✓ Additional storage space with top-mounted cabinets
- ✓ Flexible interior configuration with height adjustable shelves and convenient pull-outs



1. About us

2. Köttermann

3. Service

4. Products

5. Safety

6. Sustainability

7. References

8. Contact

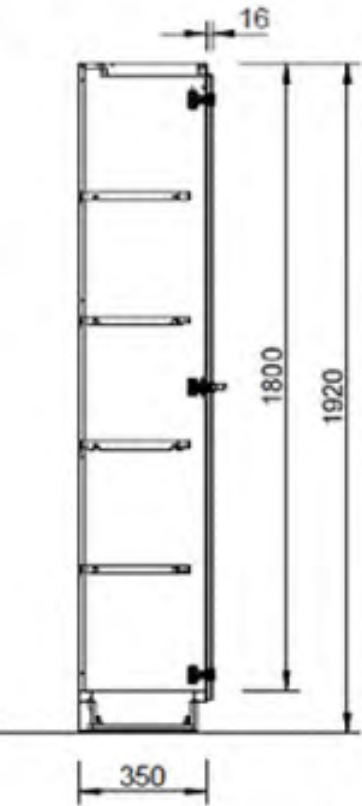

		Width			Height	Carcass depth	
Without doors	-	600	900	1200	1920	350	500
With hinged doors	-	600	900	1200	1920	350	500
With sliding glass doors	-	-	900	1200	1920	350	500
Display cabinet	-	-	900	1200	1920	350	500
Wardrobe cabinet	-	600	-	-	1920	-	500
With pull-out door	300	600	-	-	1920	-	500

Dimensions [mm]

1. About us

2. Köttermann

3. Service

4. Products

5. Safety

6. Sustainability

7. References

8. Contact



# Utensils always ready to hand

- ✓ Customized storage space as a mobile cabinet, frame base cabinet or solid with a steel plinth
- ✓ Flexibly and individually configurable
- ✓ C-frame or A-frame
- ✓ Worktops matched to your requirements



1. About us

2. Köttermann

3. Service

4. Products

5. Safety

6. Sustainability

7. References

8. Contact

	Width				Height		Carcass depth	
With steel plinth	450	600	900	1200	720	870	350	500
With steel plinth for front sink	300	-	-	-	720	870	-	500
With castors	450	600	900	1200	580	730	-	500
For installation in frames	450	600	900	1200	480	630	-	500

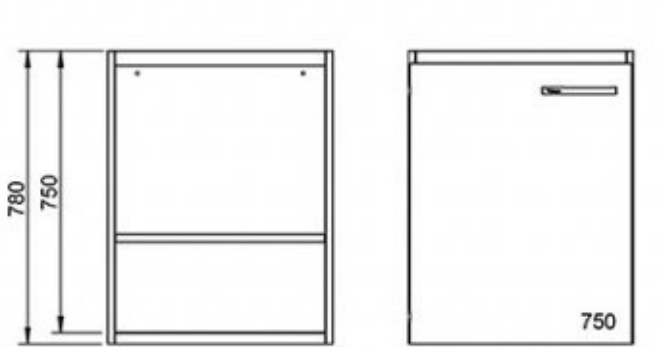

Dimensions [mm]

1. About us

2. Köttermann

3. Service

4. Products

5. Safety

6. Sustainability

7. References

8. Contact

# Utilise free space

- ✓ Unobtrusive storage space
- ✓ Diversity of variants
- ✓ Suitable for Köttermann service walls
- ✓ Optionally with practical ladder for top-mounted cabinets



1. About us

2. Köttermann

3. Service

4. Products

5. Safety

6. Sustainability

7. References

8. Contact



	Width						Height			Carcass depth	
Top-mounted cabinet for tall cabinet	-	-	600	900	1200	-	480	630	780	350	500
Wall-mounted cabinet for installation between the columns of island benches	-	-	600	900	1200	1500	480	630	-	350	-
Wall-mounted cabinet with hinged doors	-	450	600	900	1200	1500	480	630	780	350	-
Wall-mounted cabinet with sliding glass doors	-	-	-	900	1200	1500	480	630	780	350	-
First aid cabinet	-	450	-	-	-	-	480	630	780	350	-
Equipment cabinet	300	-	-	-	-	-	480	630	780	350	-

Dimensions [mm]

1. About us

2. Köttermann

3. Service

4. Products

5. Safety

6. Sustainability

7. References

8. Contact

# Easy access and potential storage space between service columns

- ✓ Access from both sides on island bench
- ✓ Optional glass doors for a light, transparent appearance
- ✓ Closed front for a uniform and orderly overall appearance



1. About us

2. Köttermann

3. Service

4. Products

5. Safety

6. Sustainability

7. References

8. Contact



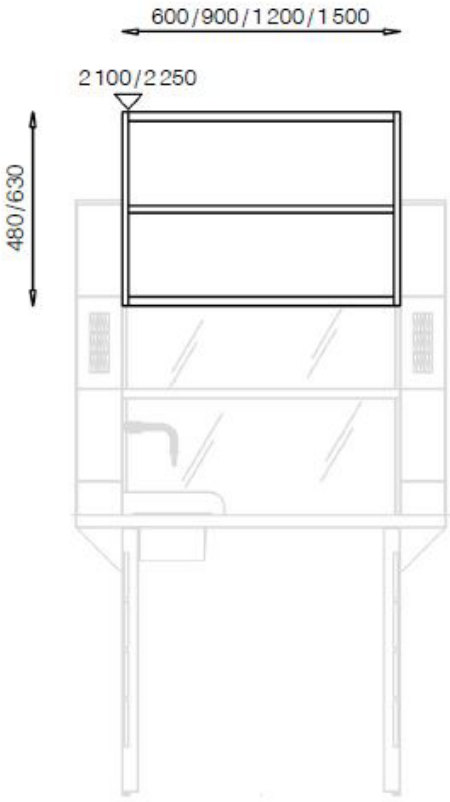

	Width					Height		Carcass depth
Open	600	900	1200	1500	1200	480	630	450
With hinged doors	600	900	1200	1500	1200	480	630	450
With sliding glass doors	-	900	1200	1500	1200	480	630	450

Dimensions [mm]

1. About us

2. Köttermann

3. Service

4. Products

5. Safety

6. Sustainability

7. References

8. Contact

# Adaptable footprint

Versatile single benches:

- ✓ Mobile with castors, load capacity up to 100 kg
- ✓ Flexibly adjustable height without castors, load capacity up to 300 kg
- ✓ Also available as a heavy-duty bench for point loads up to 200 kg or surface loads up to 400 kg



1. About us

2. Köttermann

3. Service

4. Products

5. Safety

6. Sustainability

7. References

8. Contact

# Efficient weighing – Special balance bench

- ✓ For vibration-damped weighing
- ✓ Free-standing or for integration in a bench arrangement
- ✓ Available for sitting and standing work height



1. About us

2. Köttermann

3. Service

4. Products

5. Safety

6. Sustainability

7. References

8. Contact



	Width				Height		Bench depth	
Single bench without castors	900	1200	1500	1800	750	900	600	750
Single bench with castors	900	1200	1500	1800	750	900	600	750
Heavy-duty bench		1200	1500	1800	750	900	600	750
Balance bench, free-standing	900	-	-	-	750	900	600	-
Balance bench, built-in	approx. 900	-	-	-	750	900	-	-

Dimensions [mm]

1. About us

2. Köttermann

3. Service

4. Products

5. Safety

6. Sustainability

7. References

8. Contact

# Flexible mounting: Bench frames and underbench cabinet frames

- ✓ A-frame variants ensure high load capacity
- ✓ C-frame variants optimise leg room
- ✓ Variants for octagonal worktops and underbench cabinets from 90° to 360°
- ✓ High load capacity with both variants:
  - C-frame: 250 kg/m<sup>2</sup> bench area
  - A-frame 350 kg/m<sup>2</sup> bench area

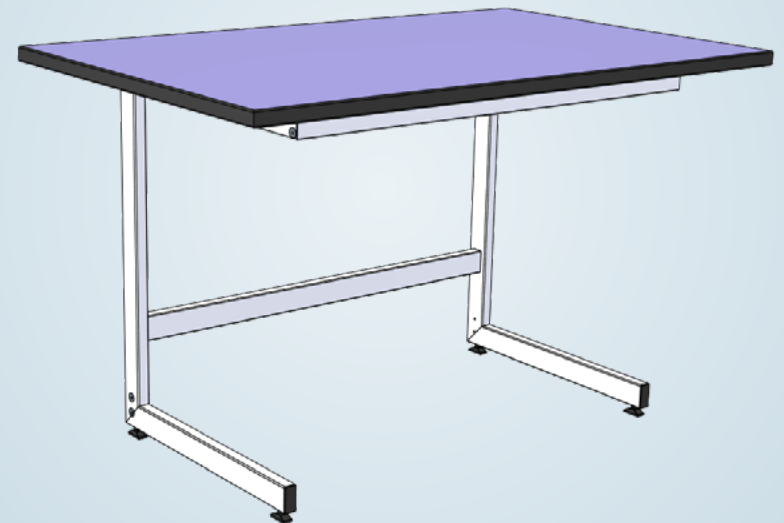

1. About us

2. Köttermann

3. Service

4. Products

5. Safety

6. Sustainability

7. References

8. Contact



	Width					Height		Bench depth		
A-frame	600	900	1200	1500	1800	720	870	600	750	900
C-frame	600	900	1200	1500	1800	720	870	600	750	900

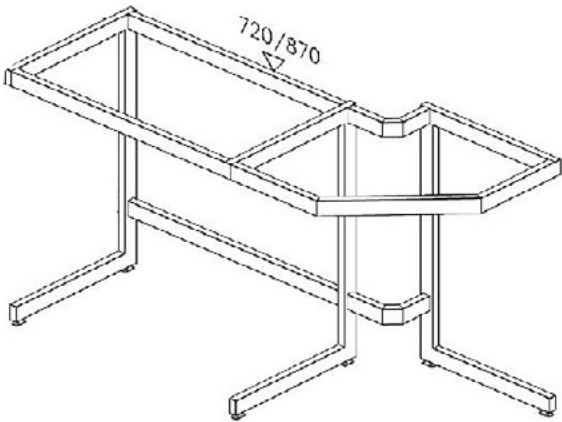

Dimensions [mm]

1. About us

2. Köttermann

3. Service

4. Products

5. Safety

6. Sustainability

7. References

8. Contact

# As diverse as your requirements

- ✓ Ten different materials for different demands
- ✓ Five variants have a marine edge to contain spilled liquids
- ✓ Diverse design options using various material combinations
- ✓ Rectangular and octagonal shapes
- ✓ Harmonious colour schemes



1. About us

2. Köttermann

3. Service

4. Products

5. Safety

6. Sustainability

7. References

8. Contact

# Colours and shapes

## ✓ Colour

- Baltic Blue (NCS S 2030 R70B)
- White (similar to RAL 9010)
- Grey (similar to RAL 7035)
- Stainless steel
- Other colours upon request

## ✓ Shapes

- Rectangular worktops
- Outside corner worktops
- Octagonal and inside corner worktops

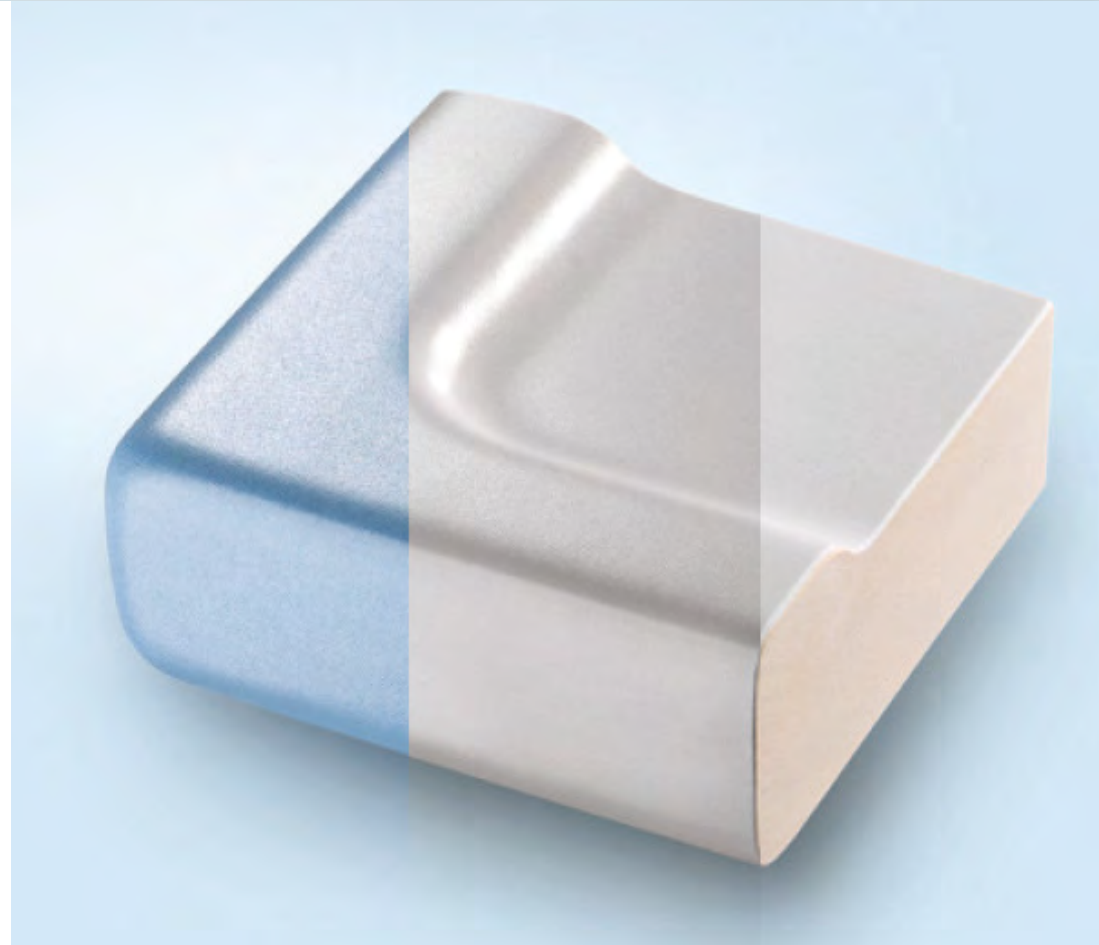

1. About us

2. Köttermann

3. Service

4. Products

5. Safety

6. Sustainability

7. References

8. Contact

# Edge finishes

- ✓ Marine edge
- ✓ Thin edging
- ✓ Thick edging
- ✓ Exposed edge

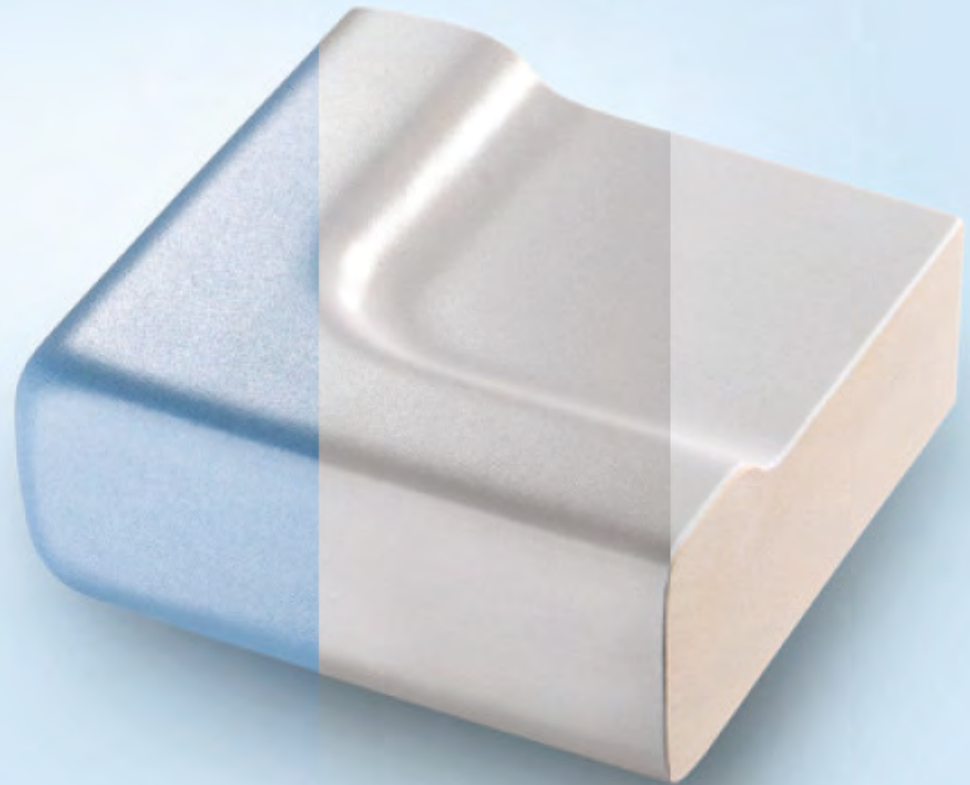

1. About us

2. Köttermann

3. Service

4. Products

5. Safety

6. Sustainability

7. References

8. Contact



Standard worktop depths	
Rectangular	400*, 600, 750, 900
Octagonal 90°	750
	900
Octagonal 180°	750
	750
	900
Octagonal 360°	900
	1500
	1800

Width: linear metre  
Depth before service wall: 670 mm and 820 mm

\* Without marine edge only

Dimensions [mm]

1. About us

2. Köttermann

3. Service

4. Products

5. Safety

6. Sustainability

7. References

8. Contact





Standard melamine



TopResist melamine



HPL / Trespa TopLab® Base

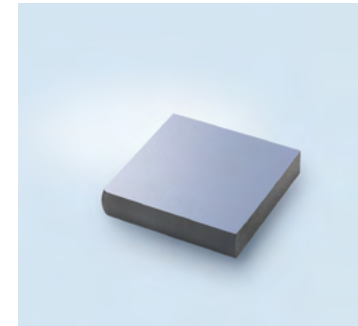

HPL / Trespa TopLab® Plus



Solid ceramic

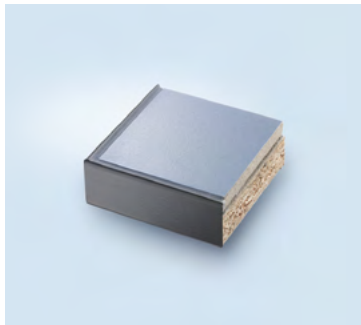

Composite ceramic

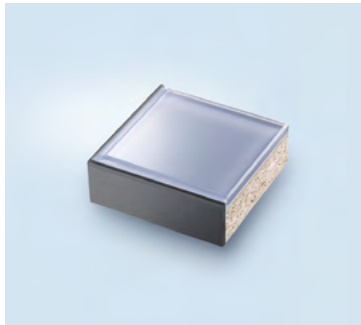

Composite glass



Polypropylene



Epoxy



Stainless steel

1. About us

2. Köttermann

3. Service

4. Products

5. Safety

6. Sustainability

7. References

8. Contact

## Worktop resistance to solvents

Solvent	Standard melamine	TopResist® melamine	Trespa® TopLab® Base	Trespa® TopLab® Plus	Ceramic / composite ceramic	Composite glass	Stainless steel	Epoxy resin	Polypropylene
Ethanol	+	+	+	+	+	+	+	+	+
Isopropanol	+	+	+	+	+	+	+	+	+
Acetone	+	+	+	+	+	+	+	+	+
Ethyl acetate	+	+	+	+	+	+	+	+	+
Trichloromethane	+	+	+	+	+	+	+	+	0
Diethyl ether	+	+	+	+	+	+	+	+	+
Toluene	+	+	+	+	+	+	+	+	–
n-Hexane	+	+	+	+	+	+	+	+	+
Cleaner's naphtha	+	+	+	+	+	+	+	+	0

+ Material very suitable; 0 Material conditionally suitable; – Material unsuitable

[1. About us](#)
[2. Köttermann](#)
[3. Service](#)
[4. Products](#)
[5. Safety](#)
[6. Sustainability](#)
[7. References](#)
[8. Contact](#)

## Worktop resistance to inorganic acids

Inorganic acids	Standard melamine	TopResist® melamine	Trespa® TopLab® Base	Trespa® TopLab® Plus	Ceramic / composite ceramic	Composite glass	Stainless steel	Epoxy resin	Polypropylene
Hydrochloric acid, concentrated	–	+	–	+	+	+	–	+	–
Sulphuric acid, concentrated	–	0	–	0	+	+	–	+	+
Sulphuric acid, 50%	–	0	–	0	+	+	–	–	+
Nitric acid, concentrated	–	0	–	0	+	+	–	–	–
Phosphoric acid, concentrated	–	+	–	+	+	+	–	0	+
Hydrofluoric acid	–	0	–	–	–	–	–	–	+

+ Material very suitable; 0 Material conditionally suitable; – Material unsuitable

[1. About us](#)
[2. Köttermann](#)
[3. Service](#)
[4. Products](#)
[5. Safety](#)
[6. Sustainability](#)
[7. References](#)
[8. Contact](#)

## Worktop resistance to organic acids and alkalis

Organic acids	Standard melamine	TopResist® melamine	Trespa® TopLab® Base	Trespa® TopLab® Plus	Ceramic / composite ceramic	Composite glass	Stainless steel	Epoxy resin	Polypropylene
Formic acid, concentrated	–	0	–	+	+	+	+	+	–
Acetic acid, concentrated	+	+	+	+	+	+	+	+	+
Alkalis	Standard melamine	TopResist® melamine	Trespa® TopLab® Base	Trespa® TopLab® Plus	Ceramic / composite ceramic	Composite glass	Stainless steel	Epoxy resin	Polypropylene
Sodium hydroxide, 20%	+	+	0	+	+	+	+	+	+
Ammonia solution, concentrated	+	+	+	+	+	+	+	+	+

+ Material very suitable; 0 Material conditionally suitable; – Material unsuitable

[1. About us](#)
[2. Köttermann](#)
[3. Service](#)
[4. Products](#)
[5. Safety](#)
[6. Sustainability](#)
[7. References](#)
[8. Contact](#)

## Worktop resistance to neutral solutions and oxidants

Neutral solutions	Standard melamine	TopResist® melamine	Trespa® TopLab® Base	Trespa® TopLab® Plus	Ceramic / composite ceramic	Composite glass	Stainless steel	Epoxy resin	Polypropylene
Formaldehyde, 25%	+	+	+	+	+	+	+	+	+
Oxidants	Standard melamine	TopResist® melamine	Trespa® TopLab® Base	Trespa® TopLab® Plus	Ceramic / composite ceramic	Composite glass	Stainless steel	Epoxy resin	Polypropylene
Hydrogen peroxide, 30%	–	+	–	+	+	+	+	+	+
Potassium permanganate, 5%	+	+	+	+	+	+	+	–	+
Potassium dichromate, 5%	+	+	+	+	+	+	+	+	+
Iodine 5% in chloroform	+	+	+	+	+	+	+	+	–

+ Material very suitable; 0 Material conditionally suitable; – Material unsuitable

[1. About us](#)
[2. Köttermann](#)
[3. Service](#)
[4. Products](#)
[5. Safety](#)
[6. Sustainability](#)
[7. References](#)
[8. Contact](#)



## Worktop resistance to reductants, dyes and stains

Reductants	Standard melamine	TopResist® melamine	Trespa® TopLab® Base	Trespa® TopLab® Plus	Ceramic / composite ceramic	Composite glass	Stainless steel	Epoxy resin	Polypropylene
Sodium sulphite, 5%	+	+	+	+	+	+	+	+	+
Dyes and stains	Standard melamine	TopResist® melamine	Trespa® TopLab® Base	Trespa® TopLab® Plus	Ceramic / composite ceramic	Composite glass	Stainless steel	Epoxy resin	Polypropylene
Eosin	+	+	+	+	+	+	+	+	+
Methylene blue	+	+	+	+	+	+	+	+	+
Crystal violet	+	+	+	+	+	+	+	+	+

+ Material very suitable; 0 Material conditionally suitable; – Material unsuitable

[1. About us](#)
[2. Köttermann](#)
[3. Service](#)
[4. Products](#)
[5. Safety](#)
[6. Sustainability](#)
[7. References](#)
[8. Contact](#)

# Where water becomes the focus

- ✓ Adapted to safety standards.
- ✓ Sink workstations with water taps and fittings, draining racks, soap and towel dispensers and eyewash stations for first aid.



1. About us

2. Köttermann

3. Service

4. Products

5. Safety

6. Sustainability

7. References

8. Contact

### **Top-mounted basin**

- All-around marine edge; larger than the worktop opening

### **Built-in basin**

- Set into the worktop

### **Welded-in basin**

- Welded seamlessly into the worktop

### **Underslung basin**

- Fastened underneath the worktop

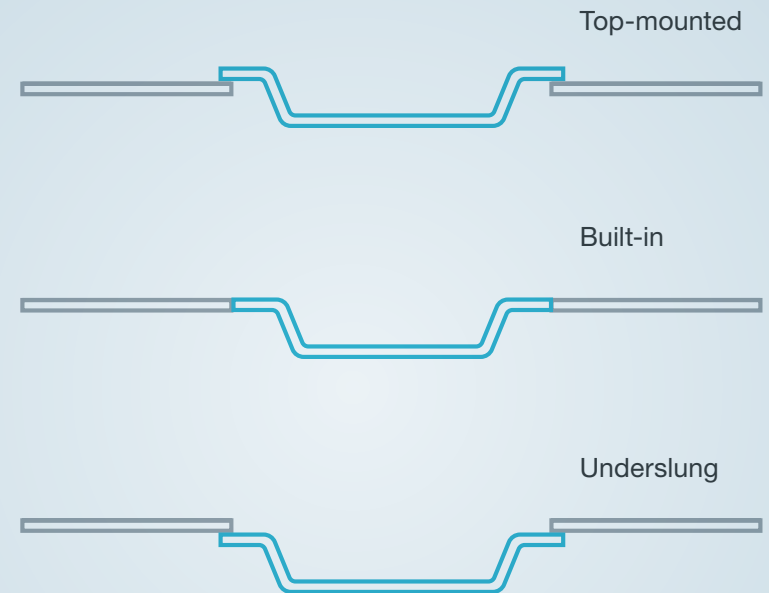

1. About us

2. Köttermann

3. Service

4. Products

5. Safety

6. Sustainability

7. References

8. Contact



	Materials	Widths	Depths	Configuration options
Basins	Ceramic, stainless steel, polypropylene, epoxy	250 – 895	100 – 500	Top mounted, flush mounted, underslung
Sinks	Ceramic, stainless steel, polypropylene	1200	600   750	Basin left/centre/right, with/without drainboard
Front sinks	Ceramic, stainless steel, polypropylene, epoxy, Trespa® TopLab® Plus	1350	680	Basin central, drainboard left and right
		1500	680	
		1650	680	
		1800	680	
		1950	680	

Dimensions [mm]

1. About us

2. Köttermann

3. Service

4. Products

5. Safety

6. Sustainability

7. References

8. Contact



Basin material / worktop material	Ceramic	Polypropylene	Stainless steel	Epoxy resin
Solid ceramic	+	-	-	-
Composite ceramic	+	-	-	-
Composite glass	+	-	-	+
Epoxy resin	-	+	+	+
Trespa/HPL	-	+	+	+
Melamine	-	+	+	+
Polypropylene	-	+	-	-
Stainless steel	-	-	+	-

Dimensions [mm]

1. About us

2. Köttermann

3. Service

4. Products

5. Safety

6. Sustainability

7. References

8. Contact



# Practical solutions for safety and convenience

Meeting your requirements: laboratory chairs, drawers with gentle automatic self-closing, mobile steps, soap or disinfectant dispensers, PC or monitor supports and much more.



1. About us

2. Köttermann

3. Service

4. Products

5. Safety

6. Sustainability

7. References

8. Contact

# An uninterrupted supply

Unrestricted access to water, electricity and gases:  
diverse solutions enable the provision of services in the  
required quality and purity.



1. About us

2. Köttermann

3. Service

4. Products

5. Safety

6. Sustainability

7. References

8. Contact

# For diverse requirements



## **Service cells**

Open for diverse options



## **Service walls**

Space-saving



## **Service booms**

Everything within reach,  
nothing in the way



## **Bench-mounted service columns**

Flexibly deployable



## **Accessories**

On the safe side in every detail

1. About us

2. Köttermann

3. Service

4. Products

5. Safety

6. Sustainability

7. References

8. Contact

# Flexibility and safety

- ✓ Interchangeable and retrofittable service cassettes
- ✓ Open design for clarity; all systems can be combined
- ✓ Power sockets, power feeds, potential equalisation, flush-mount installation boxes
- ✓ LED lighting, scaffold systems
- ✓ Splashbacks made of steel or toughened safety glass



1. About us

2. Köttermann

3. Service

4. Products

5. Safety

6. Sustainability

7. References

8. Contact

# Service cells to meet diverse needs

**Floor-mounted:** Positioned behind the worktop or separate supply

**Bench-mounted:** Fixed laboratory bench and cell unit for a greater work area



1. About us

2. Köttermann

3. Service

4. Products

5. Safety

6. Sustainability

7. References

8. Contact



# For the best possible space utilisation

- ✓ Attractive appearance and translucence
- ✓ Workplace structuring from vertical arrangement of services
- ✓ Cell cabinets and shelves provide additional room for equipment and utensils



1. About us

2. Köttermann

3. Service

4. Products

5. Safety

6. Sustainability

7. References

8. Contact

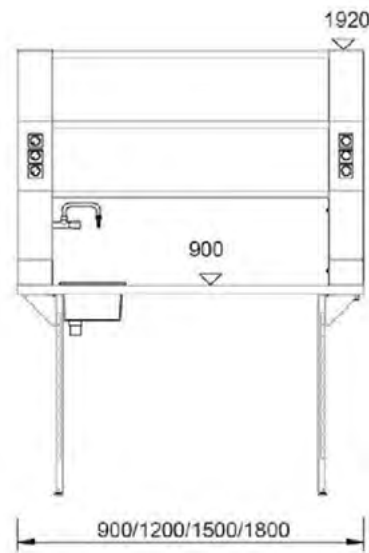

	Width				Height above top edge of floor			Height above worktop			Depth
Service cells for sitting workstations	900	1200	1500	1800	1320	1620	1920	570	870	1170	150
Service cells for standing workstations	900	1200	1500	1800	1320	1620	1920	420	720	1020	150

Dimensions [mm]

1. About us

2. Köttermann

3. Service

4. Products

5. Safety

6. Sustainability

7. References

8. Contact

# Efficient use of space

- ✓ Few joints
- ✓ High density of services
- ✓ Easily accessible
- ✓ Easy to clean
- ✓ Can also be used as partitions in the laboratory



1. About us

2. Köttermann

3. Service

4. Products

5. Safety

6. Sustainability

7. References

8. Contact

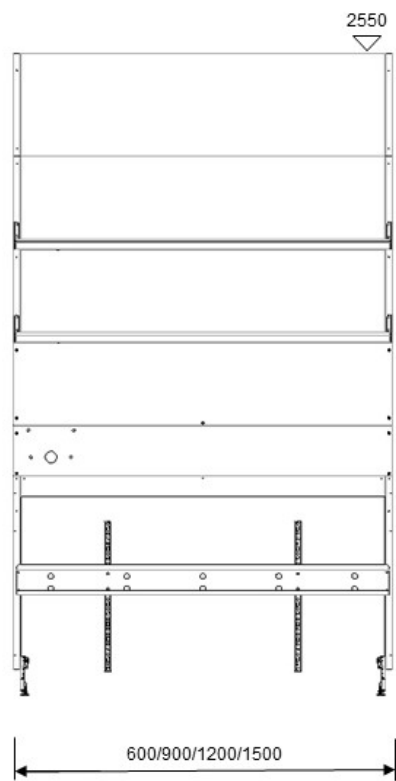

	Width				Height			Depth	
Wall workstation	600	900	1200	1500	1510	2400	2550	80	-
Dual workstation	600	900	1200	1500	1880	2400	2550	-	160

Dimensions [mm]

1. About us

2. Köttermann

3. Service

4. Products

5. Safety

6. Sustainability

7. References

8. Contact

# For maximum freedom

- ✓ More work area in the laboratory: ideal for setting up analytical equipment with service connections
- ✓ Ceiling or wall mounted, depending on available space



1. About us

2. Köttermann

3. Service

4. Products

5. Safety

6. Sustainability

7. References

8. Contact



# For your requirements

- ✓ Telescopic supports for flexible positioning
- ✓ Diverse service cassettes – suitable for your services
- ✓ Flexible cassette system enables custom fitting out and retrofitting



1. About us

2. Köttermann

3. Service

4. Products

5. Safety

6. Sustainability

7. References

8. Contact

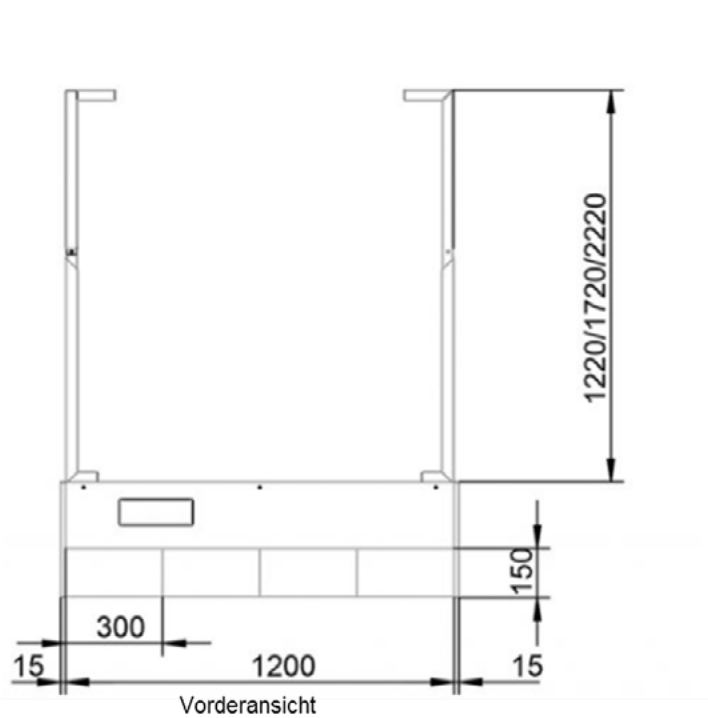

	Width			Boom height without suspension	Suspension length	Depth
Ceiling mounting	900	1200	1500	360	Adjustable up to max. 1214	200
Laboratory wall mounting	900	1200	1500	360		200

Dimensions [mm]

1. About us

2. Köttermann

3. Service

4. Products

5. Safety

6. Sustainability

7. References

8. Contact

# Utilise flexible workstations

- ✓ 360-degree access to your services:  
taps or valves, switches and power sockets
- ✓ Ideal for training rooms or work surfaces needing a  
low density of services



1. About us

2. Köttermann

3. Service

4. Products

5. Safety

6. Sustainability

7. References

8. Contact

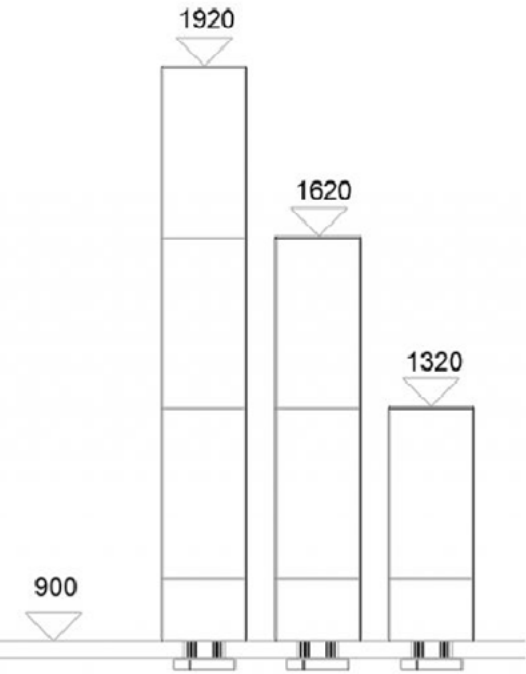

	Width	Height above top edge of floor			Height above worktop			Depth
Service columns for sitting workstations	150	1320	1620	1920	570	870	1170	150
Service columns for standing workstations	150	1320	1620	1920	420	720	1020	150

Dimensions [mm]

1. About us

2. Köttermann

3. Service

4. Products

5. Safety

6. Sustainability

7. References

8. Contact

# Quality in detail: accessories for services

From shut-off valves to regulated high-purity gases or water taps and fittings, an extensive range of accessories is available for your safe supply of services.



1. About us

2. Köttermann

3. Service

4. Products

5. Safety

6. Sustainability

7. References

8. Contact

# Safe and convenient

- ✓ Safe XXL storage space
- ✓ Top fire resistance, certified compliant with
  - **EN 14470-1** for flammable liquids
  - **EN 14470-2** for pressurised gas cylinders



1. About us

2. Köttermann

3. Service

4. Products

5. Safety

6. Sustainability

7. References

8. Contact



# Minimise hazards

- ✓ Store flammable hazardous substance safely
- ✓ Constant ventilation for a safe laboratory environment:  
via your own fume extraction system, external or  
integrated fan
- ✓ One-hand operation, automatic closure,  
full-extension pull-outs
- ✓ Access restricted to authorised persons



1. About us

2. Köttermann

3. Service

4. Products

5. Safety

6. Sustainability

7. References

8. Contact

# Safety for your hazardous substances

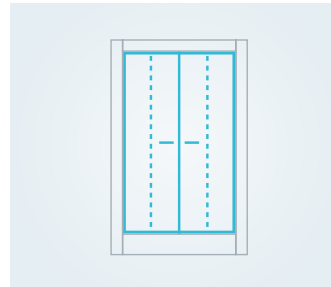

**Safety storage cabinets**  
For the storage of flammable hazardous substances

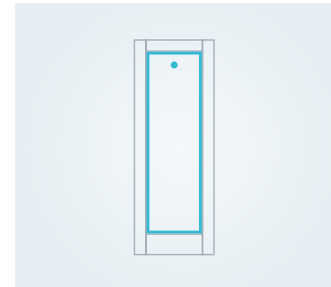

**Tall safety cabinets with pull-out doors**  
For the storage of flammable hazardous substances

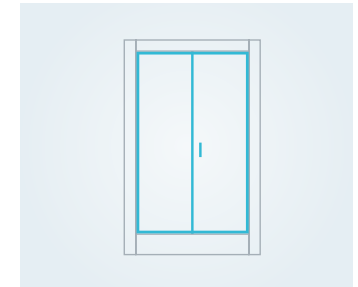

**Safety storage cabinets for pressurised gas cylinders**  
For the storage of pressurised gas cylinders

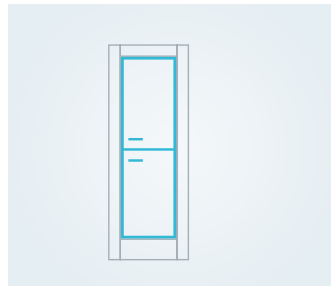

**Acid & base cabinets**  
For the storage of corrosive substances

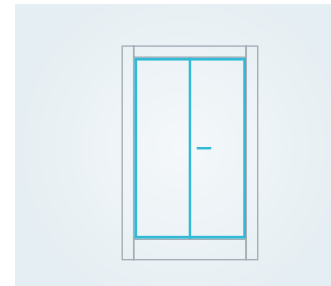

**Chemicals cabinets**  
For the storage of aggressive non-flammable chemicals and toxic substances



**First aid and fire protection**  
On the safe side in every detail

1. About us

2. Köttermann

3. Service

4. Products

5. Safety

6. Sustainability

7. References

8. Contact

# Top safety for flammable hazardous substances

- ✓ Top **fire resistance class (Type 90)**
- ✓ Proven safety: Certified compliant with **EN 14470-1** and **GS**
- ✓ Doors and carcass double-walled and thermally insulated
- ✓ Automatic thermo-mechanical door closure in the event of fire
- ✓ Integrated port for fume extraction system



1. About us

2. Köttermann

3. Service

4. Products

5. Safety

6. Sustainability

7. References

8. Contact

# Safety and convenience

- ✓ Underbench safety cabinets are storage marvels, with twice as much storage capacity for 1-litre bottles compared with conventional cabinets
- ✓ Adjustable door damping facilitates easy placement or removal of stored items



1. About us

2. Köttermann

3. Service

4. Products

5. Safety

6. Sustainability

7. References

8. Contact

### **Tall cabinets**

- ✓ Hinged or folding doors
- ✓ Optional automatic door closure
- ✓ Removable shelves and catchment trays or self-retracting pullouts in the event of fire

### **Underbench cabinets**

- ✓ Hinged doors and/or pull-outs
- ✓ Optional second level of pull-outs
- ✓ Canister with fill level monitoring



1. About us

2. Köttermann

3. Service

4. Products

5. Safety

6. Sustainability

7. References

8. Contact

Tall cabinets

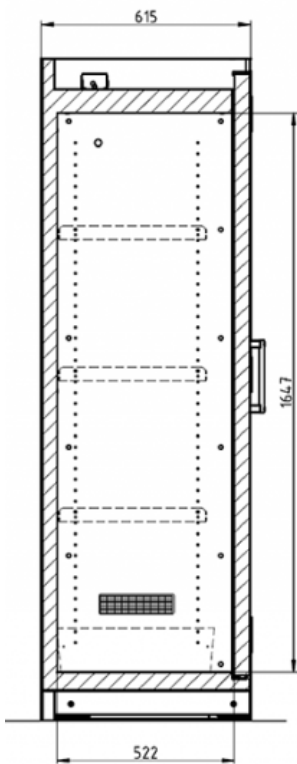

	Closure		Width		Height	Depth
1 hinged door, left or right	Manual	600	-	-	1955	615
2 hinged doors	Manual	-	900	1200	1955	615
1 hinged door, left or right	Automatic time-delayed closure	600	-	-	1955	615
2 hinged doors, one-hand operation	Automatic time-delayed closure	-	900	1200	1955	615
2 folding doors	Manual	-	-	1200	1955	615

Dimensions [mm]

1. About us

2. Köttermann

3. Service

4. Products

5. Safety

6. Sustainability

7. References

8. Contact



Underbench cabinets

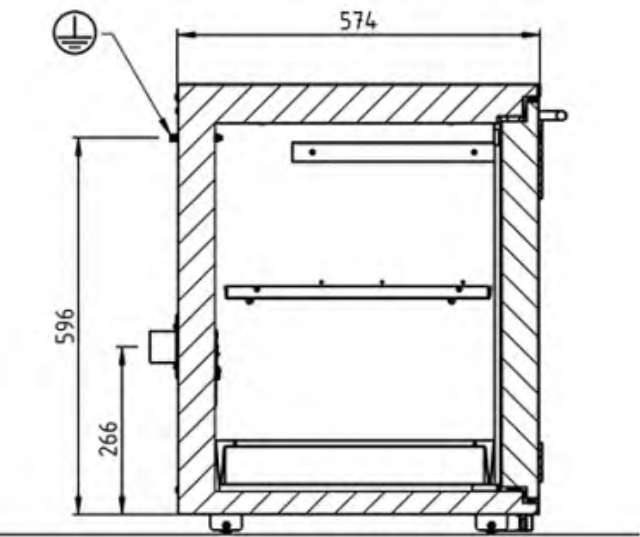

	Width				Height	Depth
1 pull-out	590	890	-	-	710	574
2 pull-outs	-	-	1100	1400	710	574
2 hinged doors	-	-	1100	-	710	574
2 hinged doors, 1 pull-out	-	-	-	1400	710	574

Dimensions [mm]

1. About us

2. Köttermann

3. Service

4. Products

5. Safety

6. Sustainability

7. References

8. Contact

# Safe and space-saving storage

- ✓ Electromagnetic mechanism for delayed closure and stop function
- ✓ Pull-out door for two-sided access and large storage capacity
- ✓ Adjustable-height shelves to meet your needs



1. About us

2. Köttermann

3. Service

4. Products

5. Safety

6. Sustainability

7. References

8. Contact

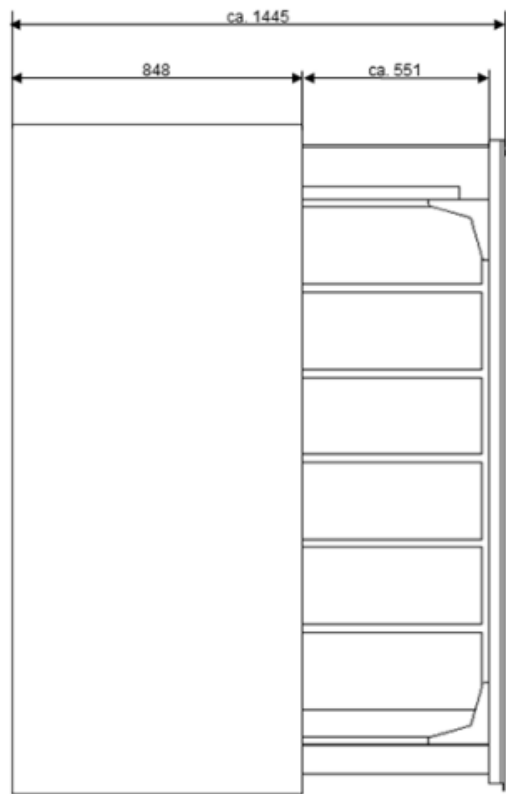

	Width		Height	Depth
Tall cabinet with pull-out door	449	819	1966	860

Dimensions [mm]

1. About us

2. Köttermann

3. Service

4. Products

5. Safety

6. Sustainability

7. References

8. Contact

# Safe storage of pressurised gas cylinders

- ✓ Top **fire resistance class (Type 90)**
- ✓ Storage of your hazardous substances in compliance with **TRGS 510 technical rules**
- ✓ Proven safety: Certified compliant with **EN 14470-2** and **GS**
- ✓ Doors and carcass double-walled and thermally insulated
- ✓ Safety lock with visual indication of lock state
- ✓ Integrated port for fume extraction system – with automatic thermo-mechanical closure



1. About us

2. Köttermann

3. Service

4. Products

5. Safety

6. Sustainability

7. References

8. Contact

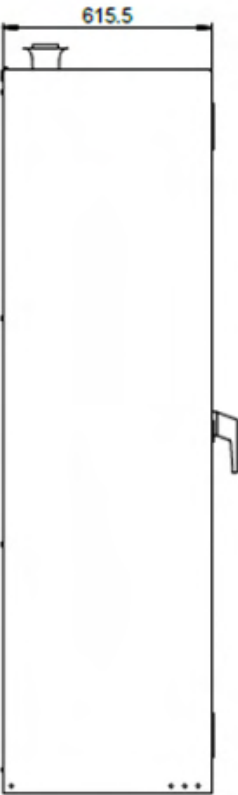

	Width				Height	Depth
Tall cabinet with hinged doors	600	900	1200	1400	2050	615
Max. number of gas cylinders	2	3	4	4	-	-

Dimensions [mm]

1. About us

2. Köttermann

3. Service

4. Products

5. Safety

6. Sustainability

7. References

8. Contact

# Protection for your laboratory environment

- ✓ Safe storage of corrosive non-flammable hazardous substances, with acids and bases separated
- ✓ Cabinet carcasses and pull-out trays made of resistant polypropylene
- ✓ Liquid-tight drawers on low-friction PTFE strips with pull-out stop
- ✓ Removal of aggressive vapours by connection to the fume extraction system
- ✓ Corrosion-resistant locks and hinges
- ✓ Ideal for installation under high-performance fume cupboards



1. About us

2. Köttermann

3. Service

4. Products

5. Safety

6. Sustainability

7. References

8. Contact



Tall cabinets

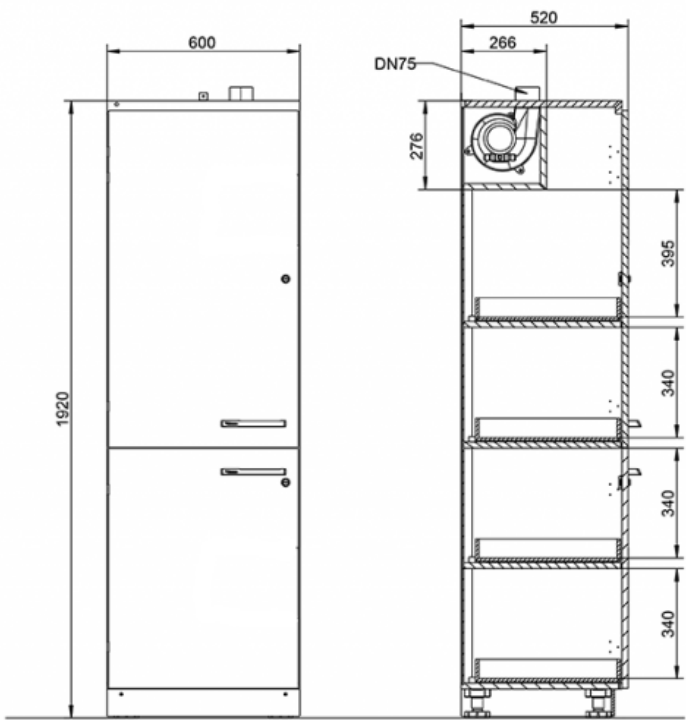

	Width			Height	Depth	Pull-outs
Tall cabinets, 1 door left/right	-	600	-	1920	520	4

Dimensions [mm]

1. About us

2. Köttermann

3. Service

4. Products

5. Safety

6. Sustainability

7. References

8. Contact

Underbench cabinets

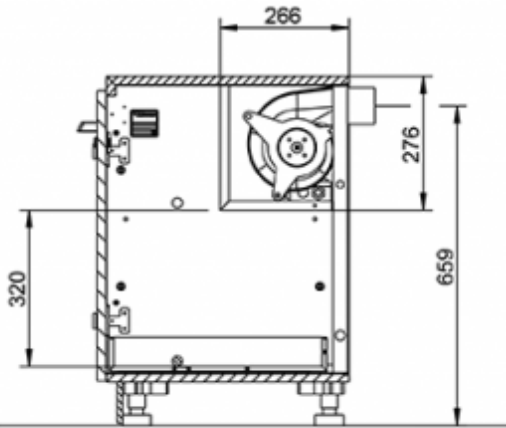

	Width						Height	Depth	Pull-outs
Underbench cabinets, 1 door left/right	450	600	-	-	-	-	720	520	2
Underbench cabinets, 2 doors	-	-	900	1100	1200	1400	720	520	3 / 4*
Underbench cabinets for cannisters 1 door left/right	450	600	-	-	-	-	720	520	1
Underbench cabinets for cannisters, 2 doors	-	-	900	1100	1200	1400	720	520	3

Dimensions [mm]

1. About us

2. Köttermann

3. Service

4. Products

5. Safety

6. Sustainability

7. References

8. Contact

# For a healthy laboratory environment

- ✓ Safe storage of aggressive non-flammable chemicals and toxic substances
- ✓ Effective vapour extraction
- ✓ Optional lockable compartment for toxic chemicals, available as a built-in compartment or as a separate wall-mounted cabinet



1. About us

2. Köttermann

3. Service

4. Products

5. Safety

6. Sustainability

7. References

8. Contact

Tall cabinets

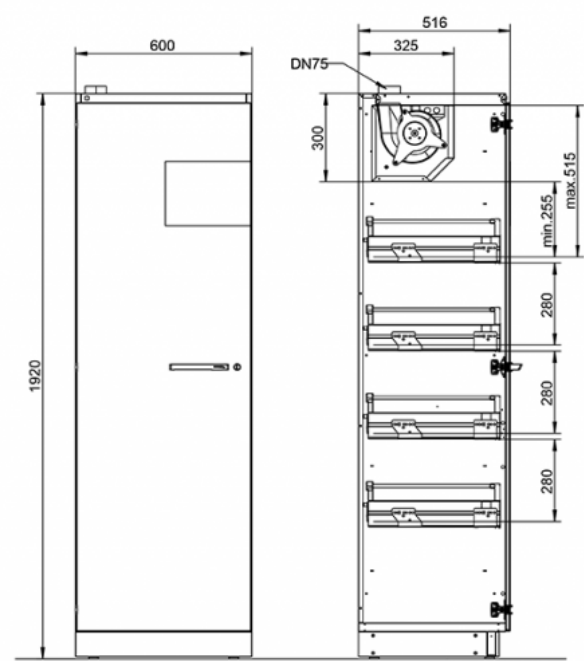

	Width		Height	Depth
Tall cabinets, 1 door left/right	600	-	1920	516
Tall cabinets, 2 doors	-	900	1200	1920

Dimensions [mm]

1. About us

2. Köttermann

3. Service

4. Products

5. Safety

6. Sustainability

7. References

8. Contact

**Underbench cabinets**

	Width			Height	Depth
Tall cabinets, 1 door left/right	600	-	-	720	516
Tall cabinets, 2 doors	-	900	1200	720	516

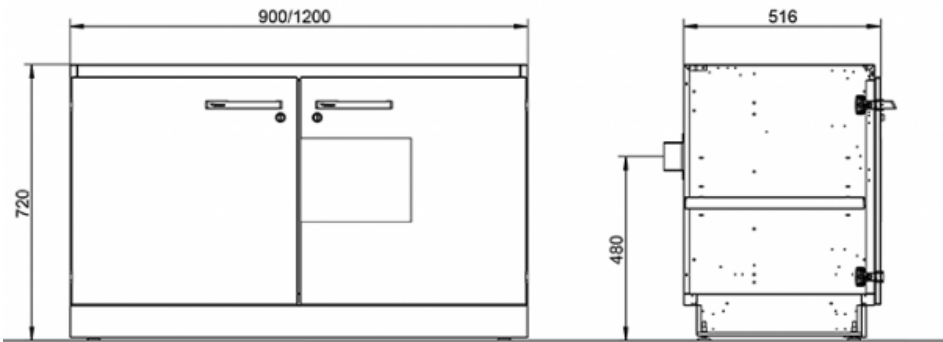

Dimensions [mm]

1. About us

2. Köttermann

3. Service

4. Products

5. Safety

6. Sustainability

7. References

8. Contact

# Ready for emergencies: first aid and fire protection accessories

We offer you an extensive range of provisions:

- ✓ Emergency showers and eyewash stations
- ✓ First aid cabinets
- ✓ First aid case with contents according to DIN 13157
- ✓ Fire extinguishers, fire blankets and much more



1. About us

2. Köttermann

3. Service

4. Products

5. Safety

6. Sustainability

7. References

8. Contact



# 5. Safety

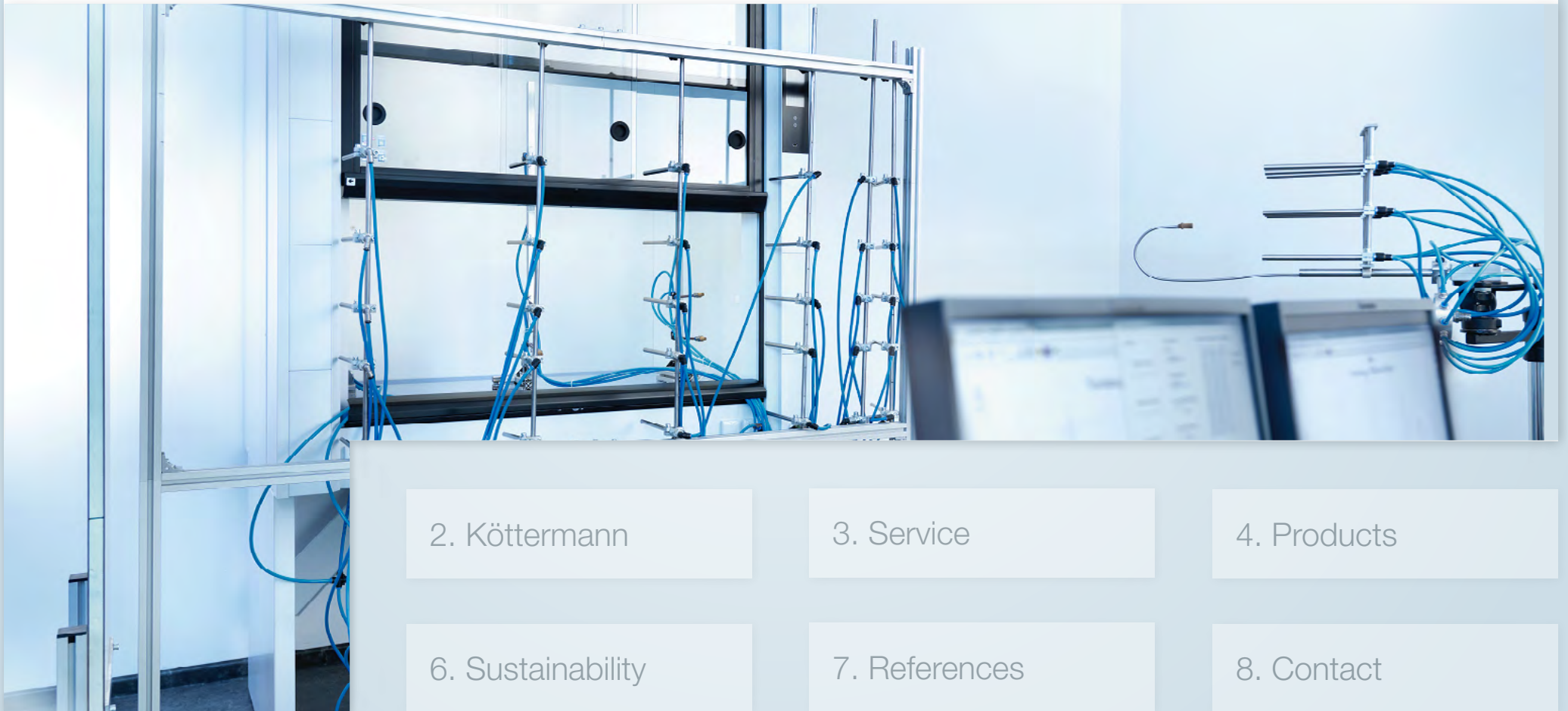

2. Köttermann

3. Service

4. Products

6. Sustainability

7. References

8. Contact

# For your safety

Your **safety** is our priority. **All of our products** are **focused** on making your work as safe and seamless as possible. Paths should be short, opening furniture and fume cupboards should be easy, and tripping hazards should be avoided.



1. About us

2. Köttermann

3. Service

4. Products

5. Safety

6. Sustainability

7. References

8. Contact

# Certificates

Our constant aim is to fulfil all safety requirements. We therefore participate in all important **audits** and **certifications**. Recently, we again passed the surveillance audit for **ISO 9001**, **ISO 14001**, **ISO 45001** and **ISO 50001**.



1. About us

2. Köttermann

3. Service

4. Products

5. Safety

6. Sustainability

7. References

8. Contact

# Köttermann test laboratory

Laboratory fume cupboards play a key protective role in the handling of hazardous substances in daily work. They are built to meet the highest safety standards and are subject to stringent controls accordingly. Our **in-house test laboratory** in Hänigsen is one of the few test facilities in Germany suitable for the precise inspection of fume cupboards.

[1. About us](#)[2. Köttermann](#)[3. Service](#)[4. Products](#)[5. Safety](#)[6. Sustainability](#)[7. References](#)[8. Contact](#)



# Room for quality

We are able to ensure the premium quality of our laboratory fume cupboards directly on site under **optimal test conditions in the test laboratory**. There we can immediately test and implement both modifications and further product development under ideal conditions.

[1. About us](#)[2. Köttermann](#)[3. Service](#)[4. Products](#)[5. Safety](#)[6. Sustainability](#)[7. References](#)[8. Contact](#)

# 6. Sustainability



1. About us

5. Safety

3. Service

7. References

4. Products

8. Contact



# Acting responsibly

Our **location** is indicative of our commitment to the natural environment. Surrounded by nature, we utilise the **resources** available to us and ensure their sustainable use.



1. About us

2. Köttermann

3. Service

4. Products

5. Safety

6. Sustainability

7. References

8. Contact

# A basis with added value

The **basis** for all of our products is **steel**, a **fully recyclable** material. Steel can be recycled over multiple life cycles, **avoiding 50 percent** of original **CO<sub>2</sub> emissions**.



1. About us

2. Köttermann

3. Service

4. Products

5. Safety

6. Sustainability

7. References

8. Contact

# Valuable resources

Our production processes are energy-intensive, so we not only pay attention to consumption, but also strive for replenishment and reduction. Our **lighting system** is linked to the intensity of solar influx, we meet **85%** of our heat demand with **waste heat** from a **nearby biogas power station**, and our **water treatment plant** reduces wastewater discharge. A **vacuum evaporator** reduces the wastewater volume of our coating facility by **98%**.

[1. About us](#)[2. Köttermann](#)[3. Service](#)[4. Products](#)[5. Safety](#)[6. Sustainability](#)[7. References](#)[8. Contact](#)



# Operating transparently

We fulfil the high requirements we set for ourselves and demonstrate this in a transparent manner. **In 1997**, we became the first company in the industry to operate an **EN ISO 14001**-certified **environmental management system**. We are also certified for **quality management** compliant with **EN ISO 9001**, **occupational health and safety** compliant with **ISO 45001**, and **energy management** compliant with **EN ISO 50001**.



1. About us

2. Köttermann

3. Service

4. Products

5. Safety

6. Sustainability

7. References

8. Contact

# 7. References



1. About us

2. Köttermann

4. Products

5. Safety

6. Sustainability

8. Contact

# Our references



National



International

1. About us

2. Köttermann

3. Service

4. Products

5. Safety

6. Sustainability

7. References

8. Contact



# National references



1. About us

2. Köttermann

3. Service

4. Products

5. Safety

6. Sustainability

7. References

8. Contact

# Hamburg University of Technology

- Laboratory for research and commissioned studies of the Institute of Environmental Technology and Energy Economy
- Location: Hamburg-Harburg / Size: 700 square metres
- Year of realisation: 2020



1. About us

2. Köttermann

3. Service

4. Products

5. Safety

6. Sustainability

7. References

8. Contact



1. About us

2. Köttermann

3. Service

4. Products

5. Safety

6. Sustainability

7. References

8. Contact



# Ludwig-Fresenius Schools

- Chemistry and galenics laboratory for vocational schools
- Location: Dortmund / Size: 1,000 square metres
- Year of realisation: 2019



1. About us

2. Köttermann

3. Service

4. Products

5. Safety

6. Sustainability

7. References

8. Contact



1. About us

2. Köttermann

3. Service

4. Products

5. Safety

6. Sustainability

7. References

8. Contact



# Continental Reifen Deutschland

- Laboratory for the automotive supplier industry
- Location: Hannover / Size: 200 square metres
- Year of realisation: 2016



1. About us

2. Köttermann

3. Service

4. Products

5. Safety

6. Sustainability

7. References

8. Contact





1. About us

2. Köttermann

3. Service

4. Products

5. Safety

6. Sustainability

7. References

8. Contact

# Münzing Chemie

- Laboratory for the production of paints and varnishes
- Location: Abstatt / Size: 1,000 square metres
- Year of realisation: 2014



1. About us

2. Köttermann

3. Service

4. Products

5. Safety

6. Sustainability

7. References

8. Contact





Münzing Chemie



1. About us

2. Köttermann

3. Service

4. Products

5. Safety

6. Sustainability

7. References

8. Contact

# Zapp Precision Metals

- Steel processing and finishing
- Location: Schwerte / Size: 70 square metres
- Year of realisation: 2016



1. About us

2. Köttermann

3. Service

4. Products

5. Safety

6. Sustainability

7. References

8. Contact





Zapp Precision Metals



1. About us

2. Köttermann

3. Service

4. Products

5. Safety

6. Sustainability

7. References

8. Contact

# Rechts der Isar Hospital

- Institute of Environmental Medicine
- Location: Munich / Size: 83 square metres
- Year of realisation: 2015



1. About us

2. Köttermann

3. Service

4. Products

5. Safety

6. Sustainability

7. References

8. Contact





Rechts der Isar Hospital



1. About us

2. Köttermann

3. Service

4. Products

5. Safety

6. Sustainability

7. References

8. Contact

# International references



1. About us

2. Köttermann

3. Service

4. Products

5. Safety

6. Sustainability

7. References

8. Contact

# Nazarbayev University, Kazakhstan

- Laboratory of the Biology faculty, School of Engineering
- Location: Astana / Size: 8,000 square metres
- Year of realisation: 2015/16



1. About us

2. Köttermann

3. Service

4. Products

5. Safety

6. Sustainability

7. References

8. Contact

# SAI Life Sciences, India

- Research laboratory
- Hyderabad / Size: 1,314 square metres
- Year of realisation: 2020



1. About us

2. Köttermann

3. Service

4. Products

5. Safety

6. Sustainability

7. References

8. Contact



# SIBUR, Russia

- Petroleum company
- Location: Moscow / Size: 1,200 square metres
- Year of realisation: 2019



1. About us

2. Köttermann

3. Service

4. Products

5. Safety

6. Sustainability

7. References

8. Contact





SIBUR, Russia



1. About us

2. Köttermann

3. Service

4. Products

5. Safety

6. Sustainability

7. References

8. Contact

# 8. Contact



1. About us

2. Köttermann

3. Service

5. Safety

6. Sustainability

7. References

**Köttermann GmbH**

Industriestraße 2

31311 Uetze

Germany

**Email** [exploris@koettermann.com](mailto:exploris@koettermann.com)

**Web** [www.koettermann.com](http://www.koettermann.com)

1. About us

2. Köttermann

3. Service

4. Products

5. Safety

6. Sustainability

7. References

8. Contact